

GE 125 LO FLURO

Spherical plain bearings

TYPE: Plain bearings, Spherical plain bearings and rod ends, Radial spherical plain bearings, Requiring maintenance, Series GE...LO (FLURO)

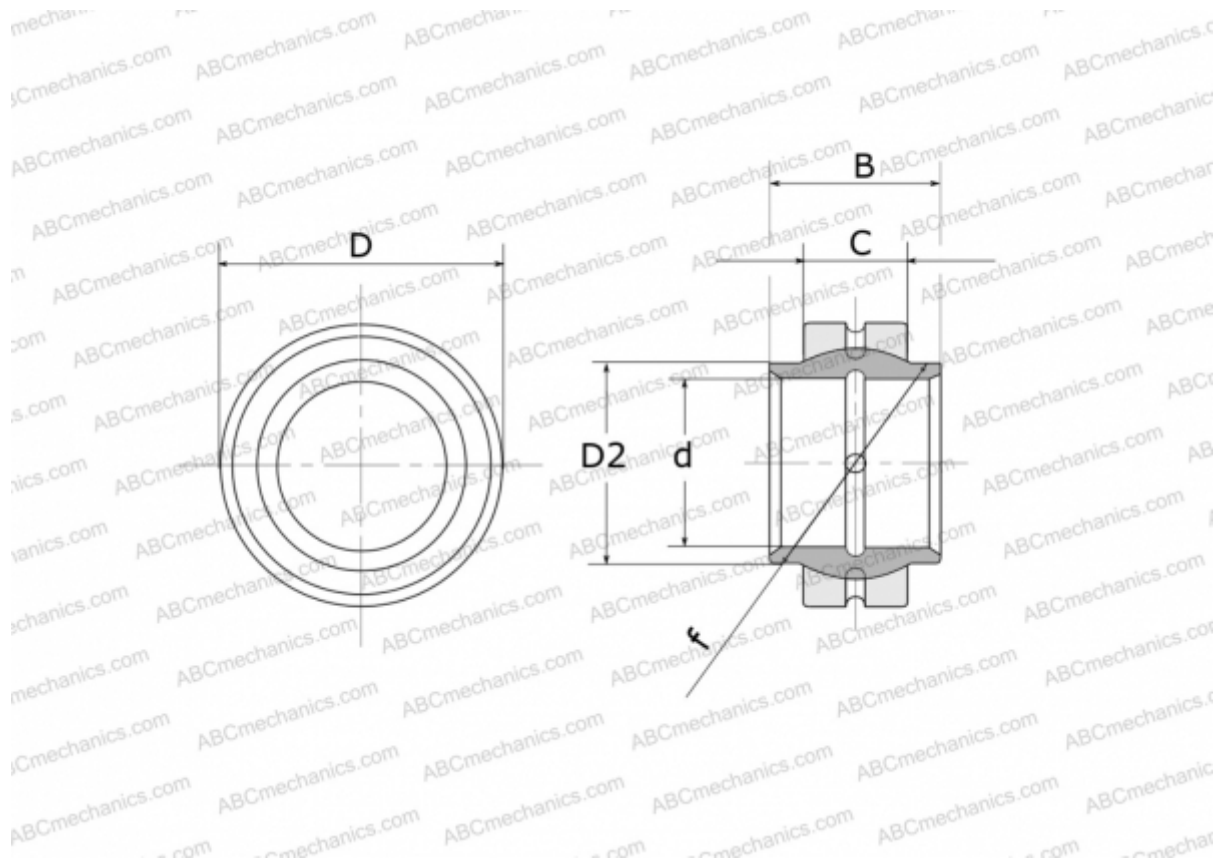

Technical specification

DIMENSIONS, MM

d	125,000
D	180,000
D2	138,000
B	125,000
f	160,000
C	70,000

WEIGHT, KG 8,190

MANUFACTURER [FLURO](#)