

GE 160 LO FLURO

Spherical plain bearings

TYPE: Plain bearings, Spherical plain bearings and rod ends, Radial spherical plain bearings, Requiring maintenance, Series GE...LO (FLURO)

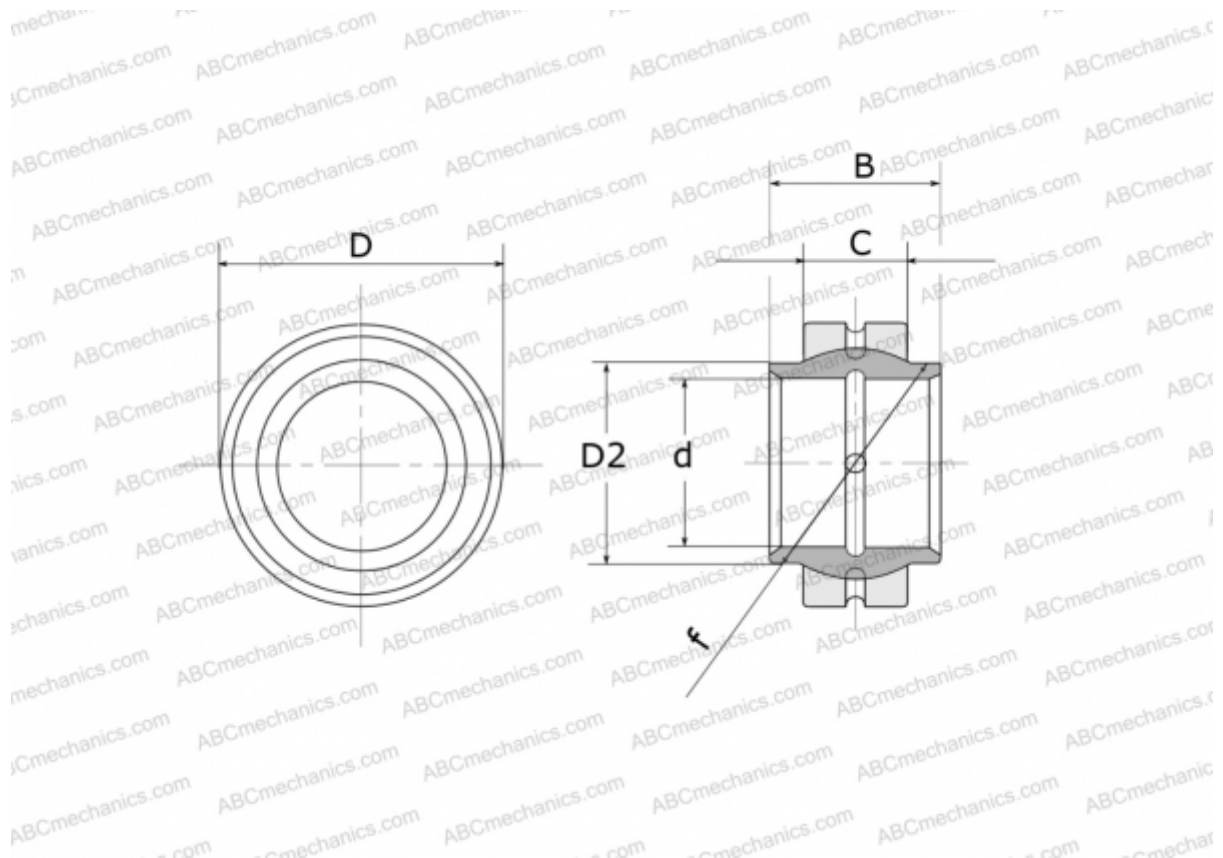

Technical specification

DIMENSIONS, MM

d	160,000
D	230,000
D2	177,000
B	160,000
f	200,000
C	80,000

WEIGHT, KG 15,800

MANUFACTURER [FLURO](#)