

GE 200 LO FLURO

Spherical plain bearings

TYPE: Plain bearings, Spherical plain bearings and rod ends, Radial spherical plain bearings, Requiring maintenance, Series GE...LO (FLURO)

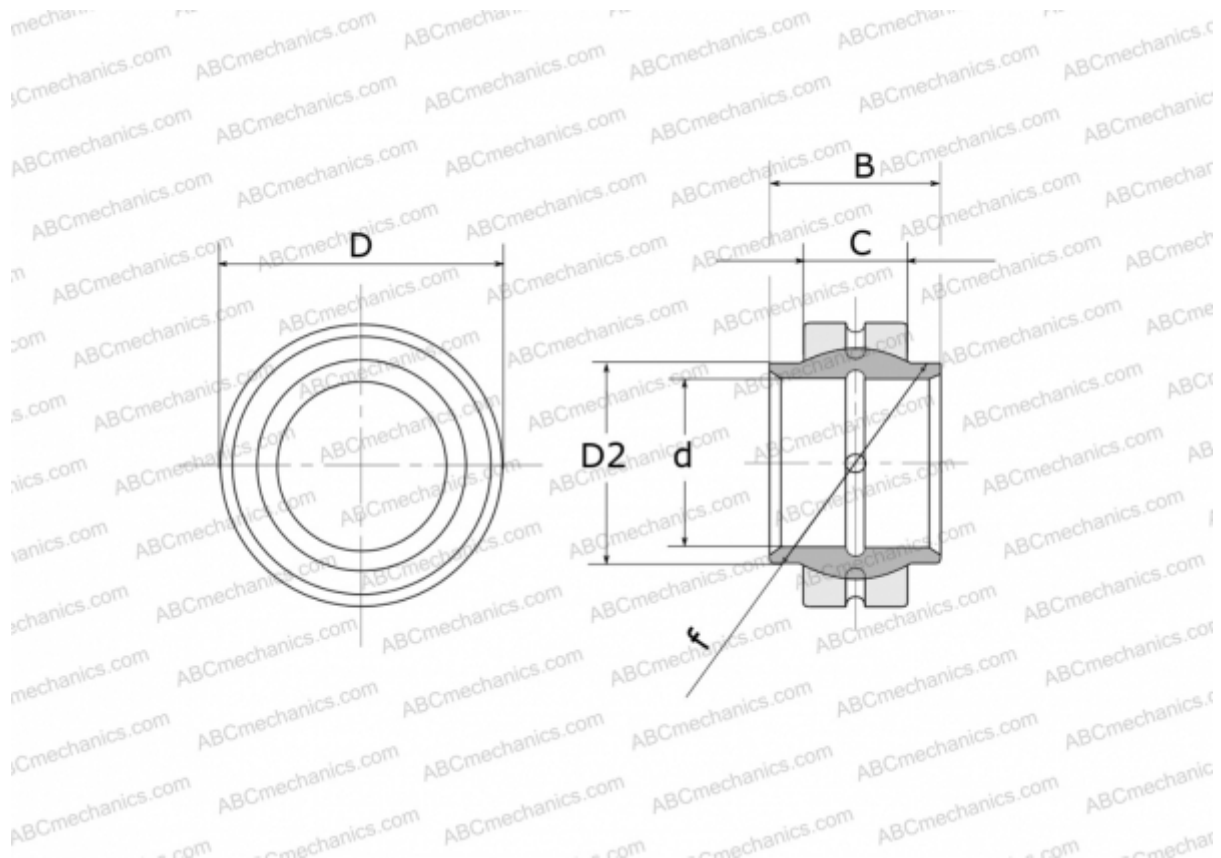

Technical specification

DIMENSIONS, MM

d	200,000
D	290,000
D2	221,000
B	200,000
f	250,000
C	100,000

WEIGHT, KG 31,700

MANUFACTURER [FLURO](#)