

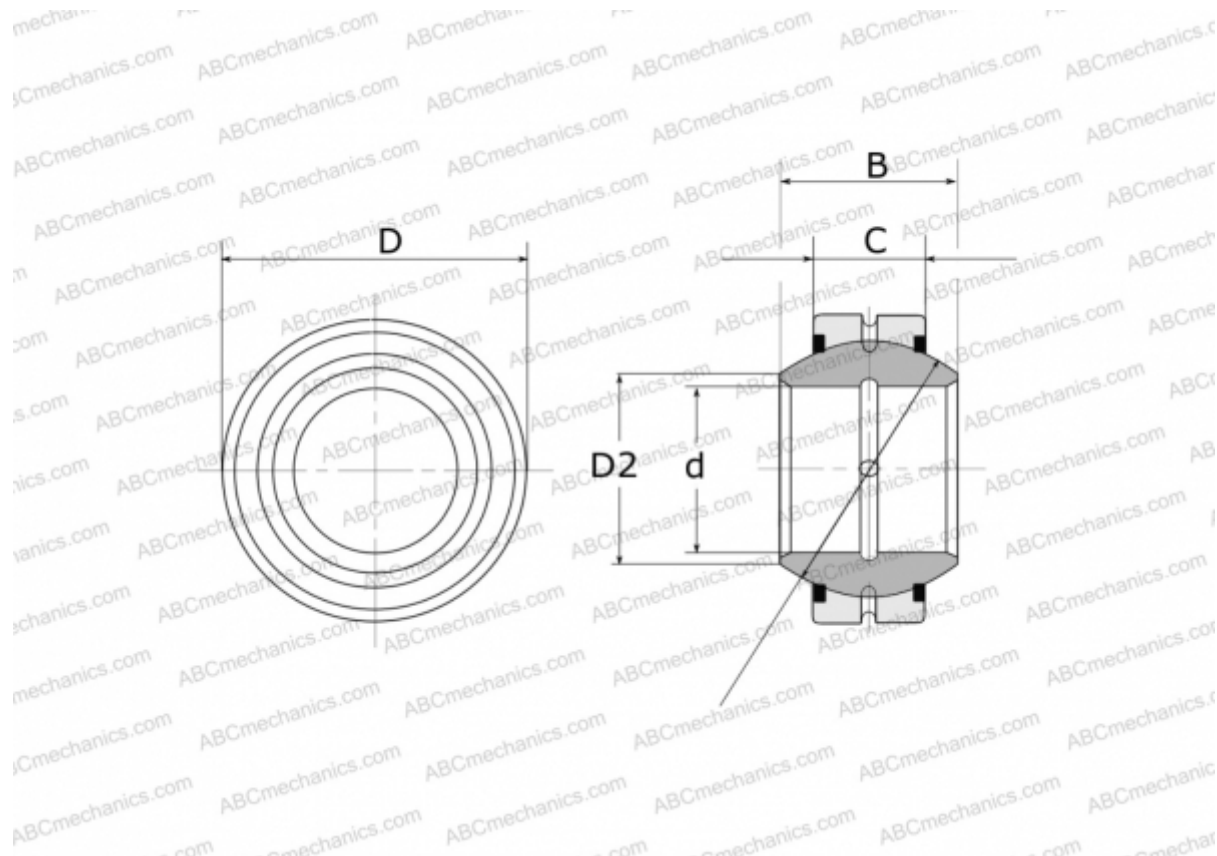

GE 30 FO-2RS FLURO

Spherical plain bearings

TYPE: Plain bearings, Spherical plain bearings and rod ends, Radial spherical plain bearings, Requiring maintenance, Series GE...FO-2RS (FLURO), contact seals on both side



Technical specification

DIMENSIONS, MM

d	30,000
D	55,000
D2	34,400
B	32,000
f	47,000
C	20,000

WEIGHT, KG 0,296

MANUFACTURER [FLURO](#)

