

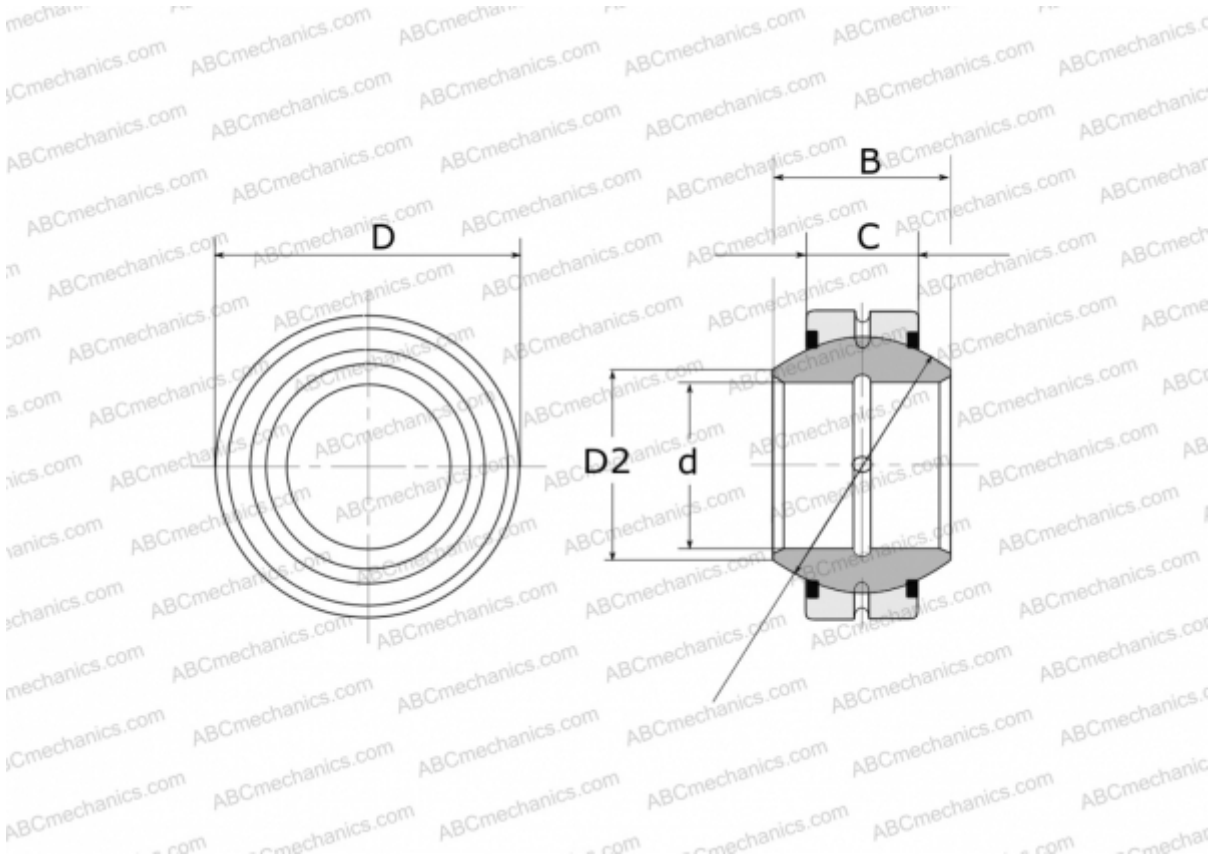

GE 50 FO-2RS FLURO

Spherical plain bearings

TYPE: Plain bearings, Spherical plain bearings and rod ends, Radial spherical plain bearings, Requiring maintenance, Series GE...FO-2RS (FLURO), contact seals on both side



Technical specification

DIMENSIONS, MM	
d	50,000
D	90,000
D2	57,100
B	56,000
f	80,000
C	36,000
WEIGHT, KG	
	1,420
MANUFACTURER	
	FLURO

