

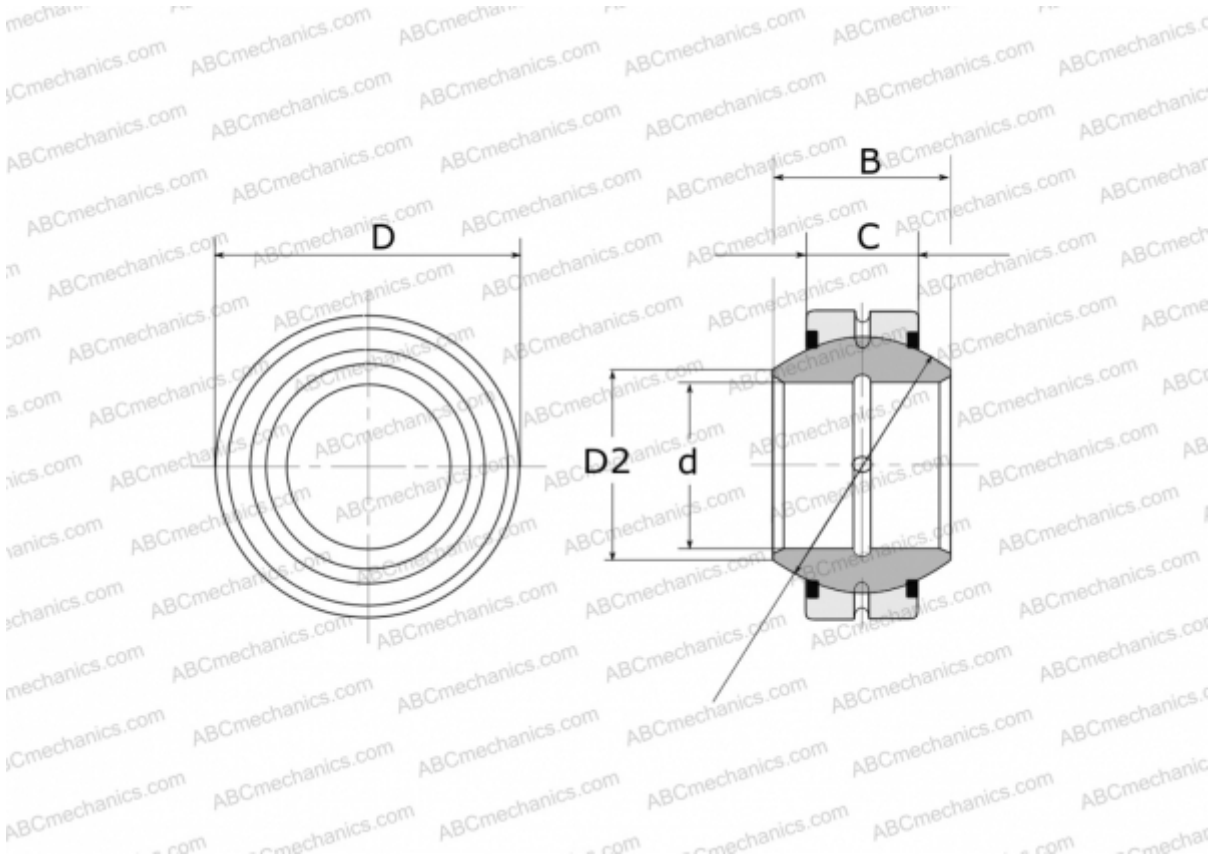

GE 60 FO-2RS FLURO

Spherical plain bearings

TYPE: Plain bearings, Spherical plain bearings and rod ends, Radial spherical plain bearings, Requiring maintenance, Series GE...FO-2RS (FLURO), contact seals on both side



Technical specification

DIMENSIONS, MM	
d	60,000
D	105,000
D2	67,000
B	63,000
f	92,000
C	40,000
WEIGHT, KG	
	2,090
MANUFACTURER	
	FLURO

