

GE 90 FO-2RS FLURO

Spherical plain bearings

TYPE: Plain bearings, Spherical plain bearings and rod ends, Radial spherical plain bearings, Requiring maintenance, Series GE...FO-2RS (FLURO), contact seals on both side

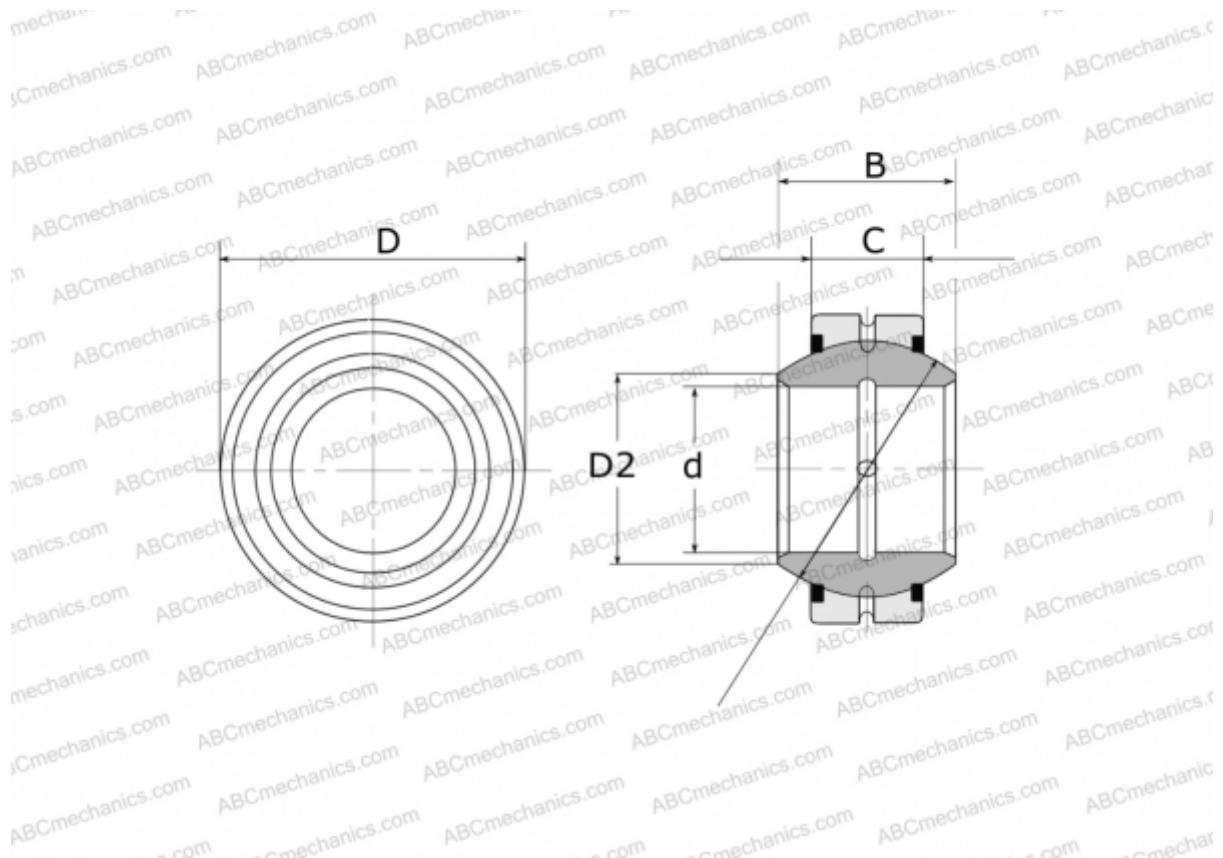

Technical specification

DIMENSIONS, MM

d	90,000
D	150,000
D2	98,300
B	85,000
f	130,000
C	55,000

WEIGHT, KG 5,500

MANUFACTURER [FLURO](#)