

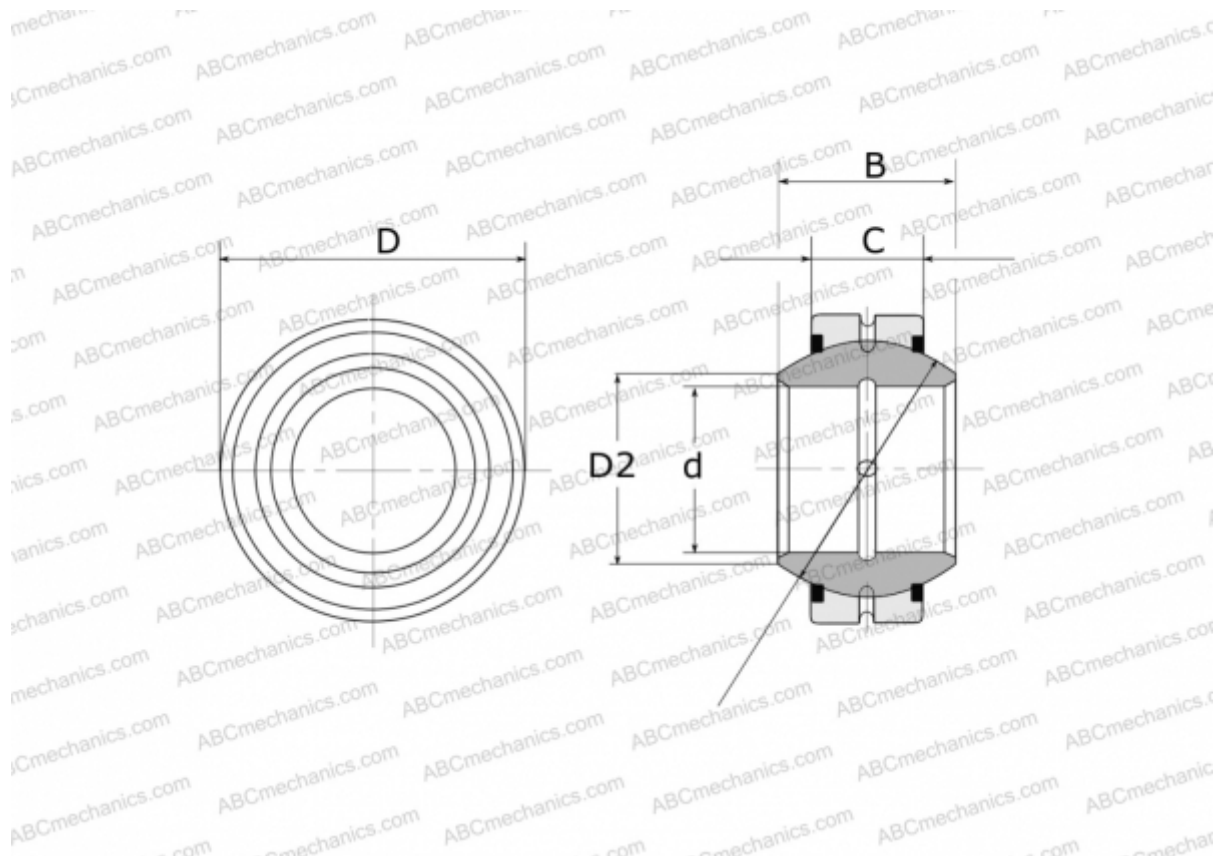

## GE 110 FO-2RS FLURO

Spherical plain bearings

TYPE: Plain bearings, Spherical plain bearings and rod ends, Radial spherical plain bearings, Requiring maintenance, Series GE...FO-2RS (FLURO), contact seals on both side



### Technical specification

#### DIMENSIONS, MM

d	110,000
D	180,000
D2	124,800
B	100,000
f	160,000
C	70,000

**WEIGHT, KG** 9,740

**MANUFACTURER** [FLURO](#)

