

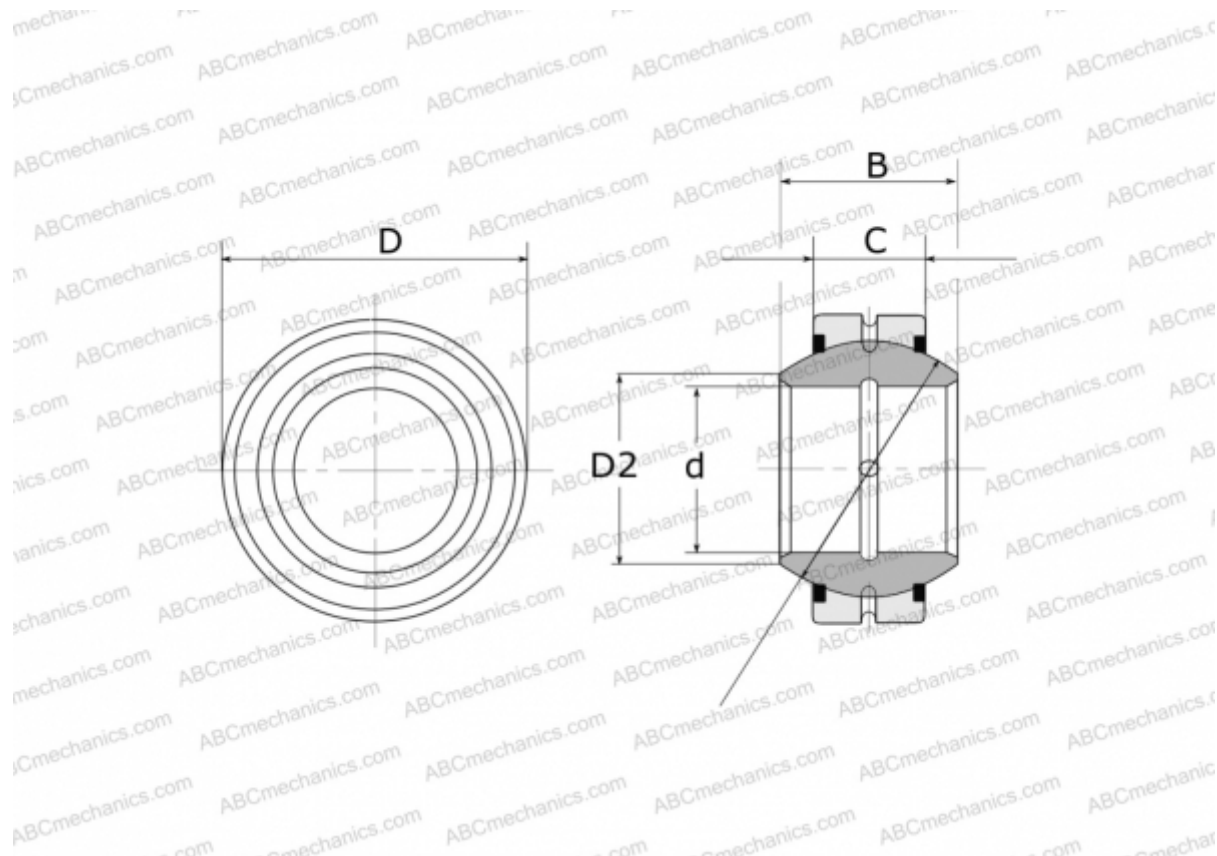

GE 120 FO-2RS FLURO

Spherical plain bearings

TYPE: Plain bearings, Spherical plain bearings and rod ends, Radial spherical plain bearings, Requiring maintenance, Series GE...FO-2RS (FLURO), contact seals on both side



Technical specification

DIMENSIONS, MM

d	120,000
D	210,000
D2	138,400
B	115,000
f	180,000
C	70,000

WEIGHT, KG 15,100

MANUFACTURER [FLURO](#)

