

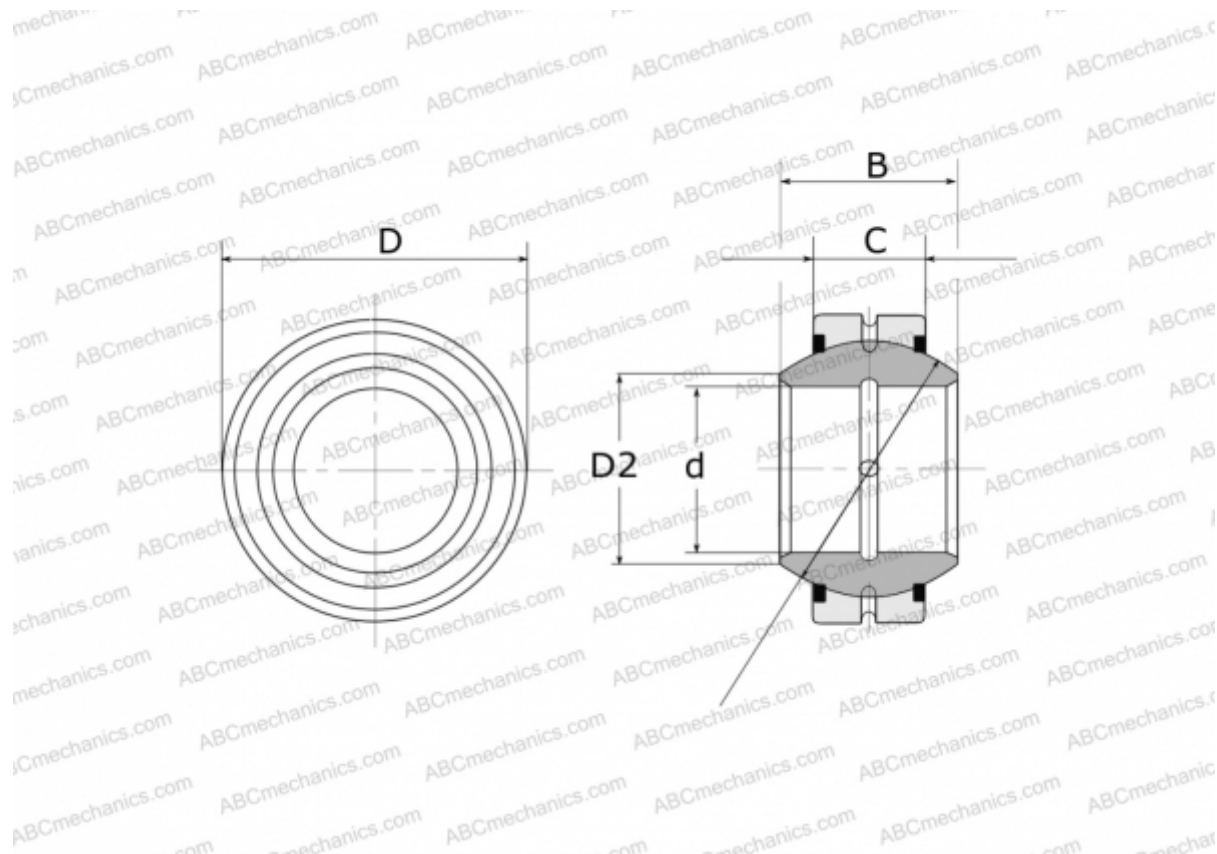

GE 140 FO-2RS FLURO

Spherical plain bearings

TYPE: Plain bearings, Spherical plain bearings and rod ends, Radial spherical plain bearings, Requiring maintenance, Series GE...FO-2RS (FLURO), contact seals on both side



Technical specification

DIMENSIONS, MM

d	140,000
D	230,000
D2	151,900
B	130,000
f	200,000
C	80,000

WEIGHT, KG 18,900

MANUFACTURER [FLURO](#)

