

GE 160 FO-2RS FLURO

Spherical plain bearings

TYPE: Plain bearings, Spherical plain bearings and rod ends, Radial spherical plain bearings, Requiring maintenance, Series GE...FO-2RS (FLURO), contact seals on both side

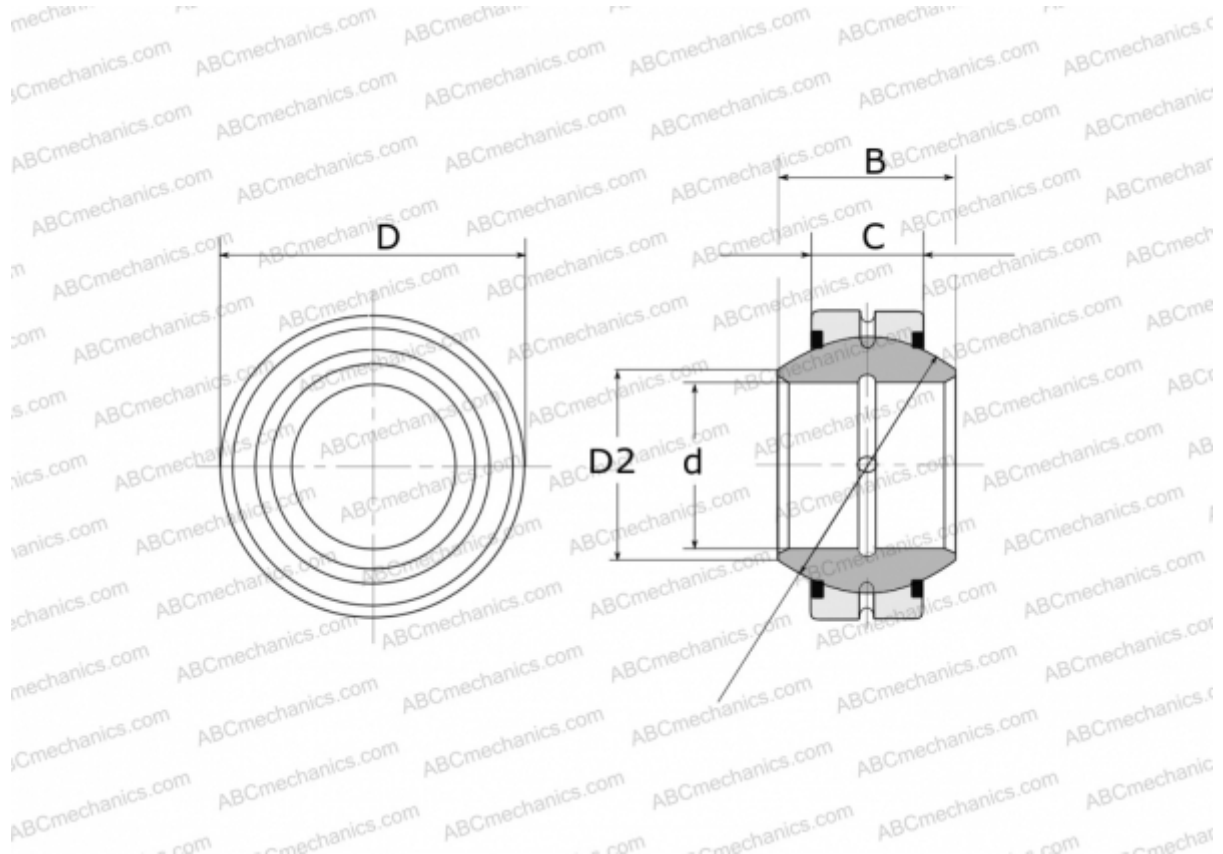

Technical specification

DIMENSIONS, MM

d	160,000
D	260,000
D2	180,000
B	135,000
f	225,000
C	80,000

WEIGHT, KG 24,800

MANUFACTURER [FLURO](#)