

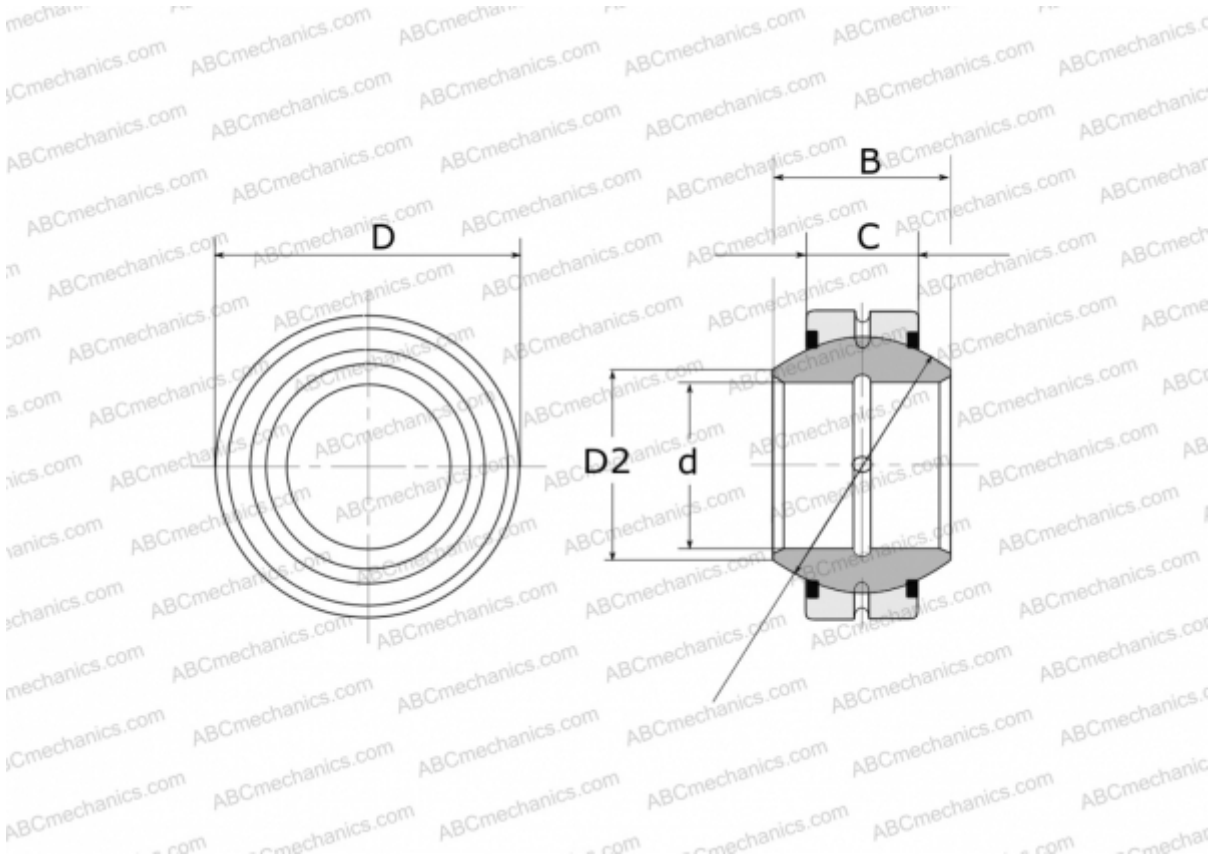

GE 200 FO-2RS FLURO

Spherical plain bearings

TYPE: Plain bearings, Spherical plain bearings and rod ends, Radial spherical plain bearings, Requiring maintenance, Series GE...FO-2RS (FLURO), contact seals on both side



Technical specification

DIMENSIONS, MM	
d	200,000
D	320,000
D2	220,000
B	165,000
f	275,000
C	100,000
WEIGHT, KG	
	44,900
MANUFACTURER	
	FLURO

