

GE 220 FO-2RS FLURO

Spherical plain bearings

TYPE: Plain bearings, Spherical plain bearings and rod ends, Radial spherical plain bearings, Requiring maintenance, Series GE...FO-2RS (FLURO), contact seals on both side

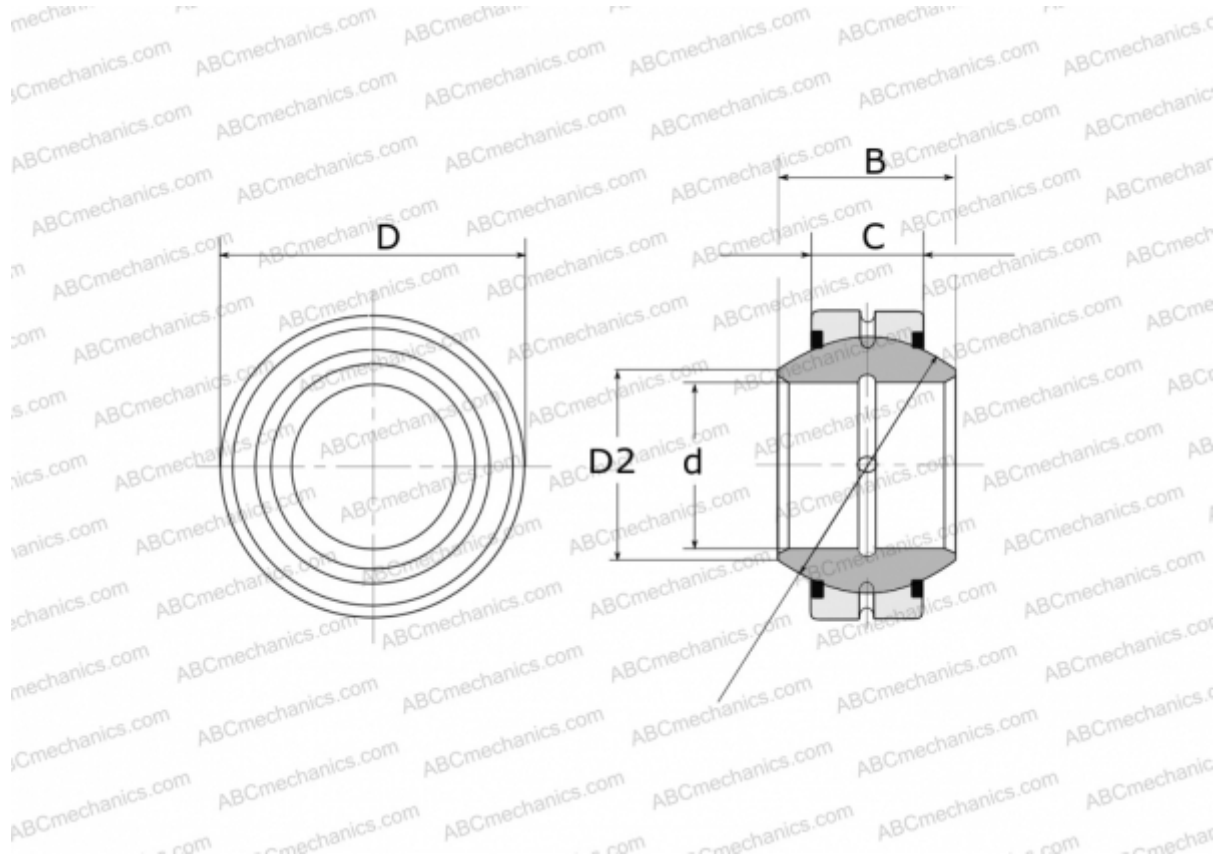

Technical specification

DIMENSIONS, MM

d	220,000
D	340,000
D2	243,600
B	175,000
f	300,000
C	100,000

WEIGHT, KG 50,900

MANUFACTURER [FLURO](#)