

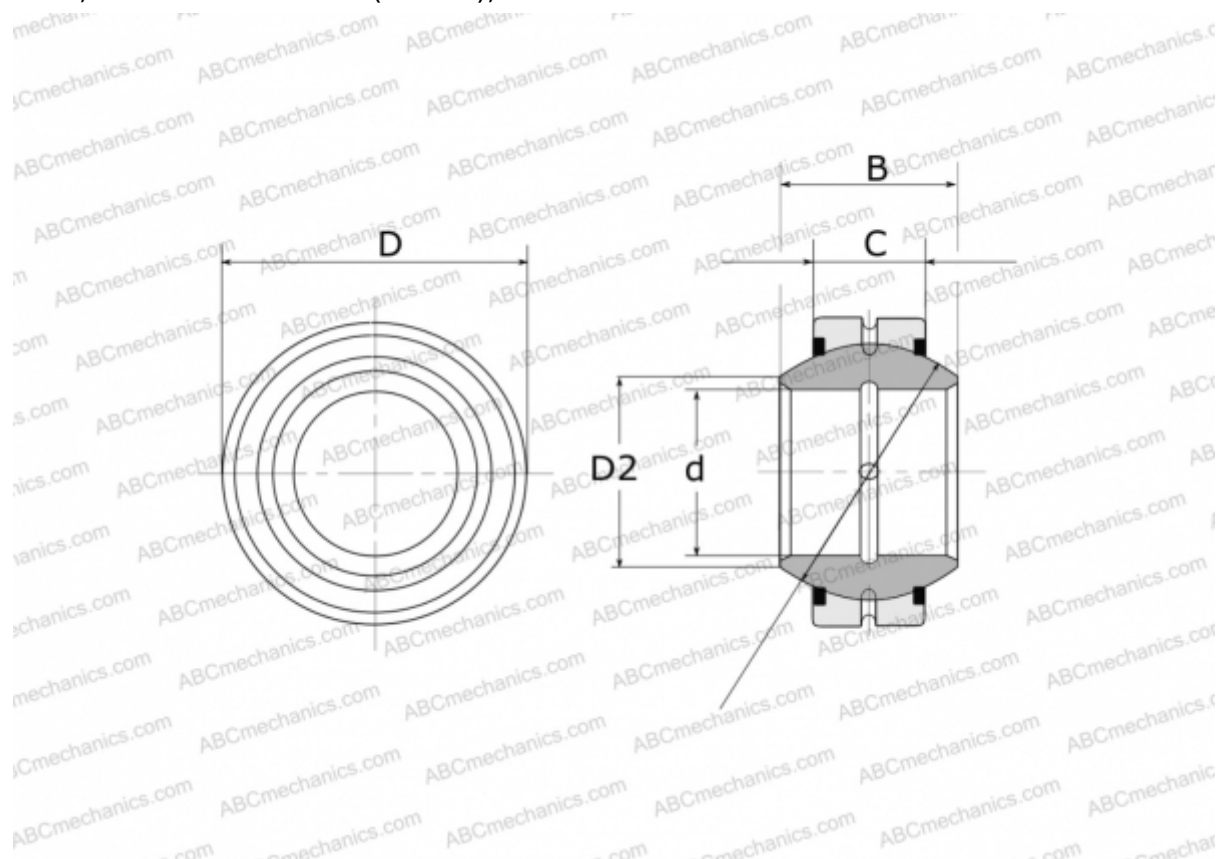

GE 240 FO-2RS FLURO

Spherical plain bearings

TYPE: Plain bearings, Spherical plain bearings and rod ends, Radial spherical plain bearings, Requiring maintenance, Series GE...FO-2RS (FLURO), contact seals on both side



Technical specification

DIMENSIONS, MM

| | |
|----|---------|
| d | 240,000 |
| D | 370,000 |
| D2 | 263,600 |
| B | 190,000 |
| f | 325,000 |
| C | 110,000 |

WEIGHT, KG 65,300

MANUFACTURER [FLURO](#)

