

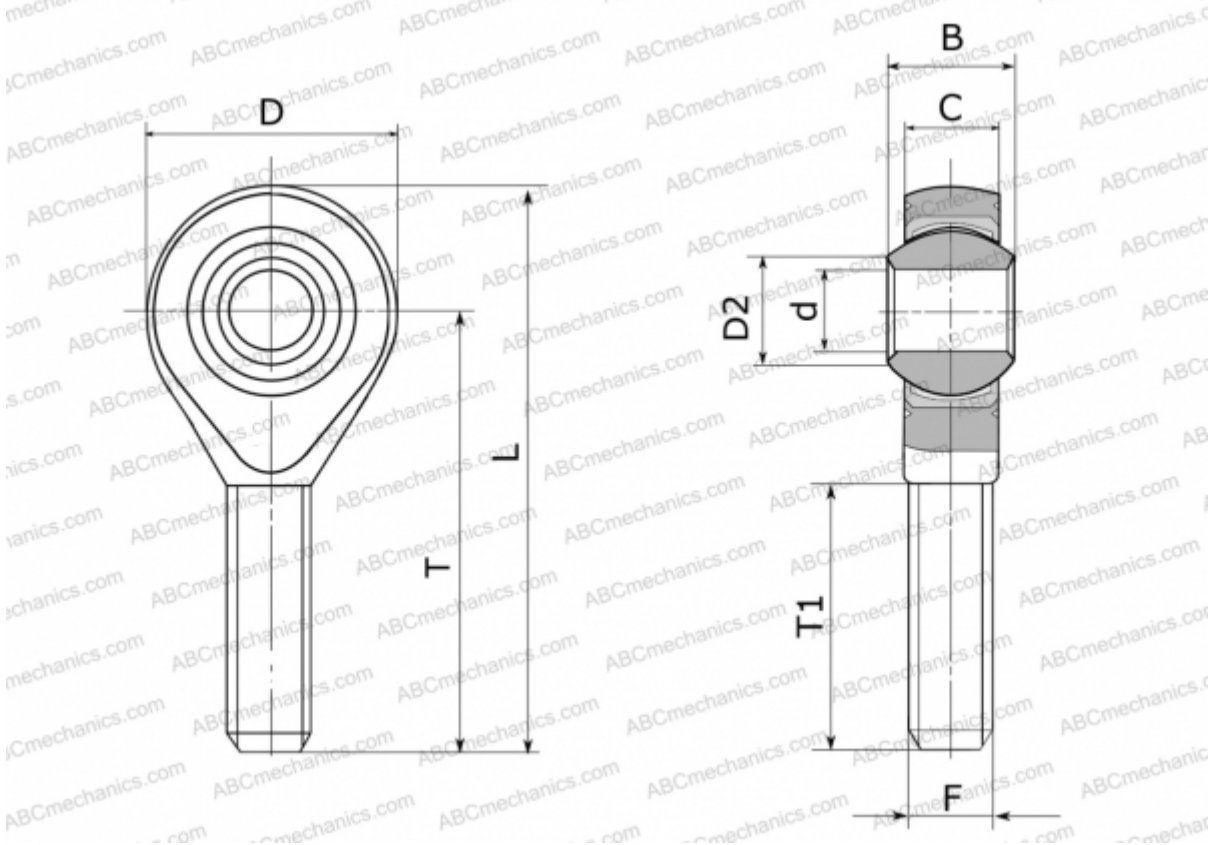

GAKSR12-PS ELGES

TYPE: Plain bearings, Spherical plain bearings and rod ends, Rod ends, Maintenance free, With external thread, open design, right hand thread, corrosion-resistant, series GAKSR..-PS (INA)



Technical specification

DIMENSIONS, MM	
d	12,000
D	33,000
D2	15,400
B	16,000
L	70,500
T	54,000
T1	32,000
C	12,000
F	M12

WEIGHT, KG 0,090

MANUFACTURER [ELGES](#)

