

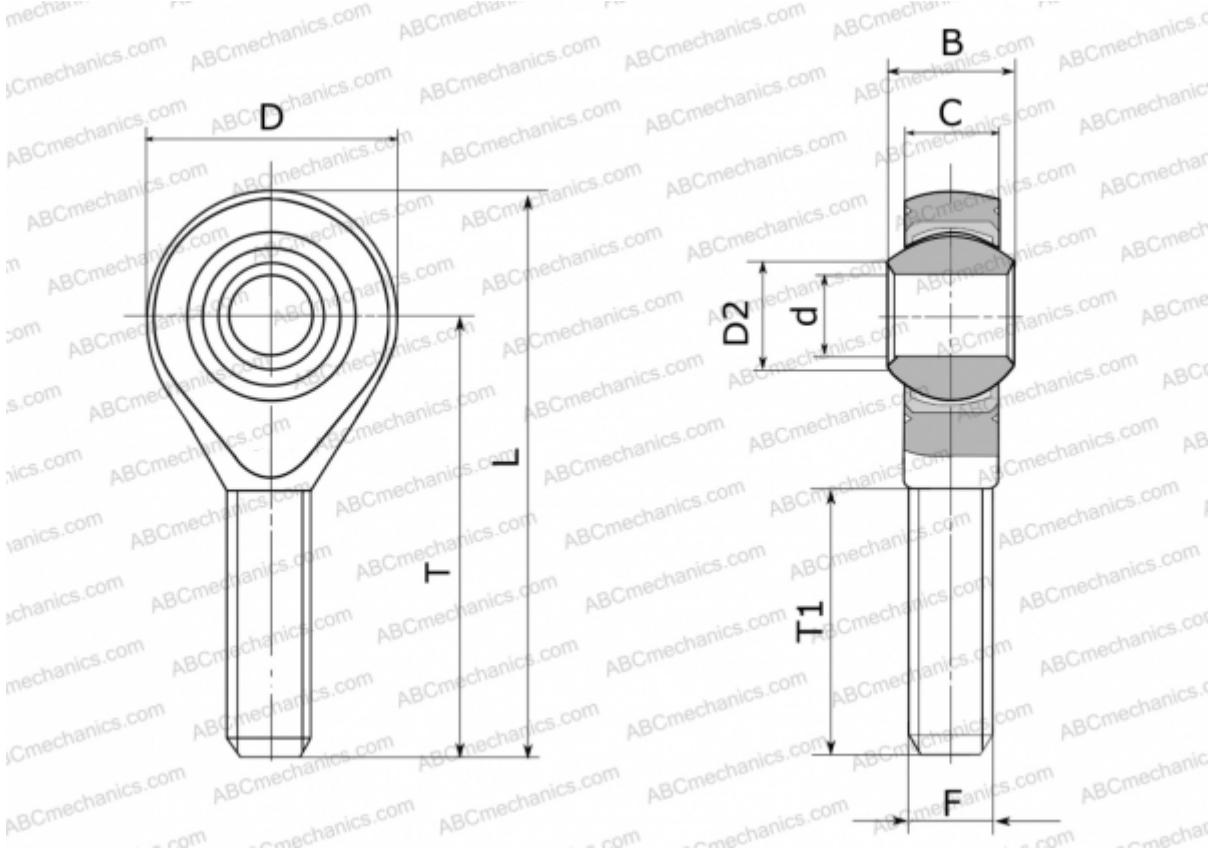

GASW 6 FLURO

TYPE: Plain bearings, Spherical plain bearings and rod ends, Rod ends, Maintenance free, With external thread, open design, right hand thread, series GASW (FLURO)



Technical specification

| DIMENSIONS, MM | |
|----------------|--------|
| d | 6,000 |
| D | 20,000 |
| D2 | 8,900 |
| B | 9,000 |
| L | 46,000 |
| T | 36,000 |
| T1 | 21,000 |
| C | 6,750 |
| F | M 6 |

WEIGHT, KG 0,020

MANUFACTURER [FLURO](#)

