

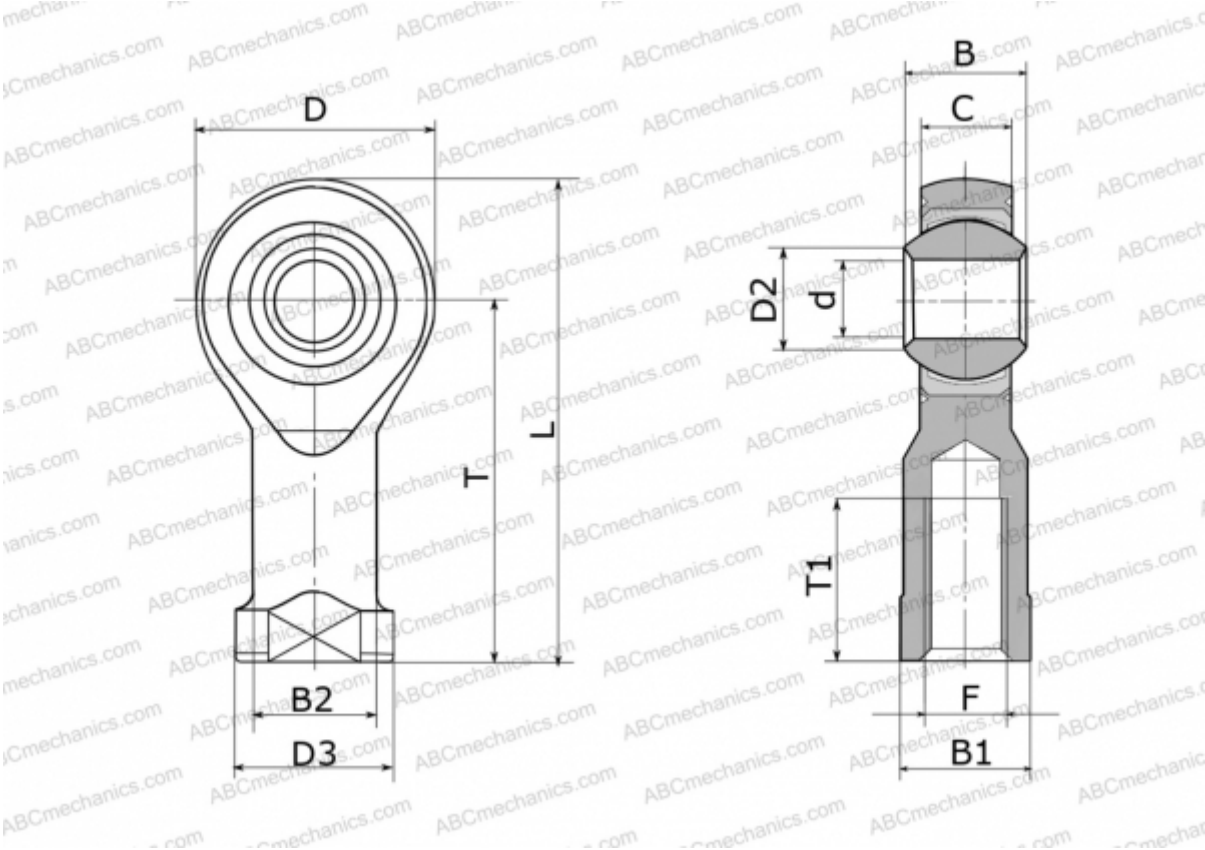

GILXSW 35 FLURO

TYPE: Plain bearings, Spherical plain bearings and rod ends, Rod ends, Maintenance free, With internal thread, open design, left hand thread, series GILXSW (FLURO)



Technical specification

DIMENSIONS, MM

|    |         |
|----|---------|
| d  | 35,000  |
| D  | 80,000  |
| D2 | 37,700  |
| D3 | 58,000  |
| B  | 43,000  |
| B1 | 50,000  |
| B2 | 46,000  |
| L  | 165,000 |
| T  | 125,000 |
| T1 | 56,000  |
| C  | 28,000  |
| F  | M 36x2  |

WEIGHT, KG

1,600

MANUFACTURER

[FLURO](#)

