

## GARSW 25 FLURO

TYPE: Plain bearings, Spherical plain bearings and rod ends, Rod ends, Maintenance free, With external thread, open design, right hand thread, stainless steel, series GARSW (FLURO)

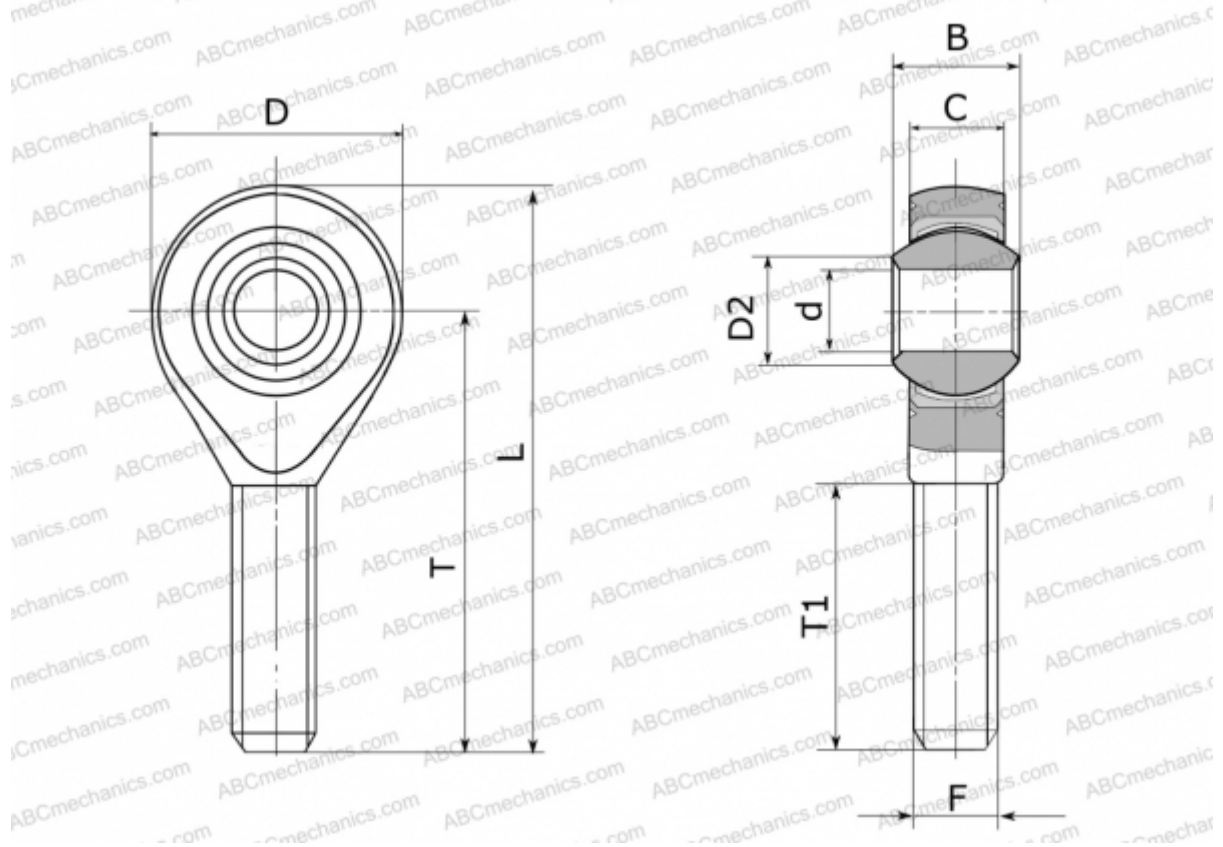

### Technical specification

#### DIMENSIONS, MM

d	25,000
D	60,000
D2	29,600
B	31,000
L	124,000
T	94,000
T1	57,000
C	22,000
F	M 24x2

**WEIGHT, KG** 0,600

**MANUFACTURER** [FLURO](#)