

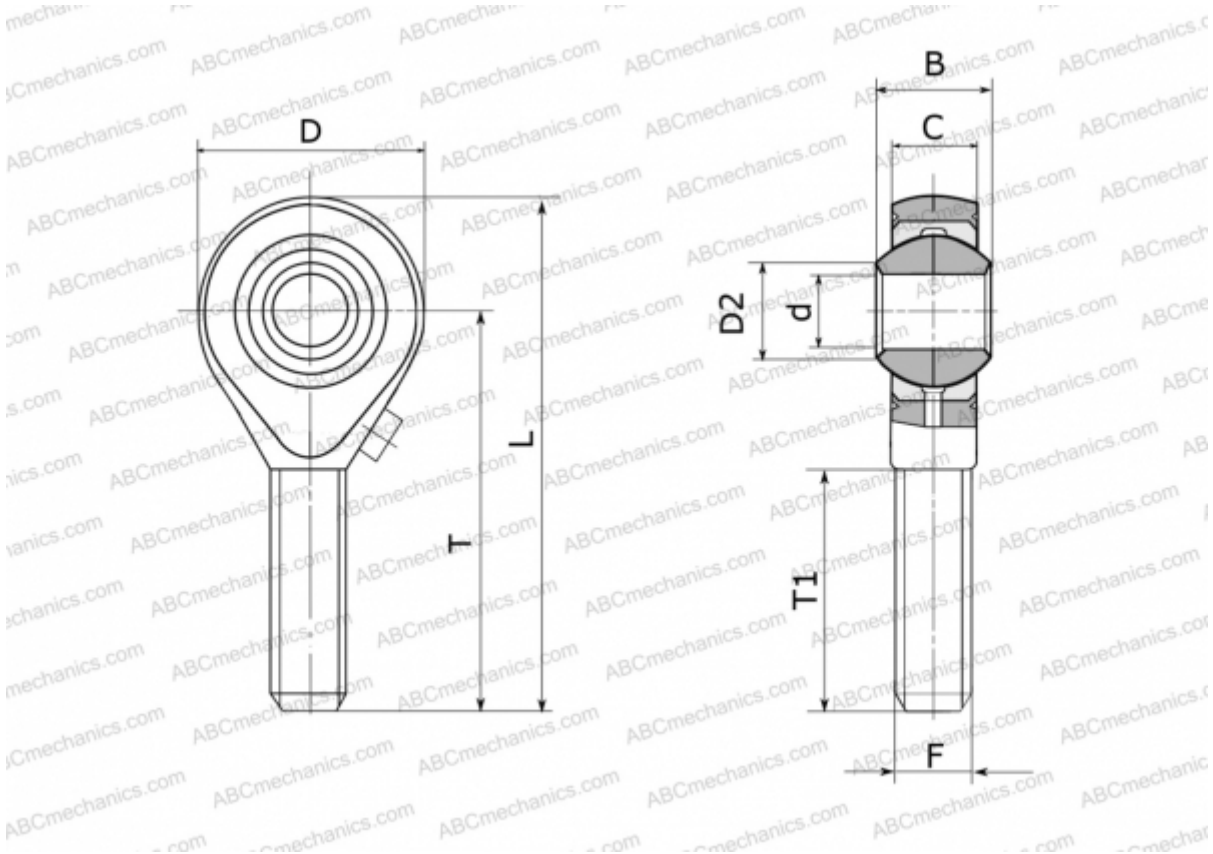

GAS 2 FLURO

TYPE: Plain bearings, Spherical plain bearings and rod ends, Rod ends, Requiring maintenance, With external thread, open design, right hand thread, series GAS (FLURO)



Technical specification

DIMENSIONS, MM	
d	2,000
D	9,000
D2	2,600
B	4,500
L	24,500
T	20,000
T1	12,000
C	3,600
F	M 2

WEIGHT, KG 0,003

MANUFACTURER [FLURO](#)

