

GAS 40 FLURO

TYPE: Plain bearings, Spherical plain bearings and rod ends, Rod ends, Requiring maintenance, With external thread, open design, right hand thread, series GAS (FLURO)

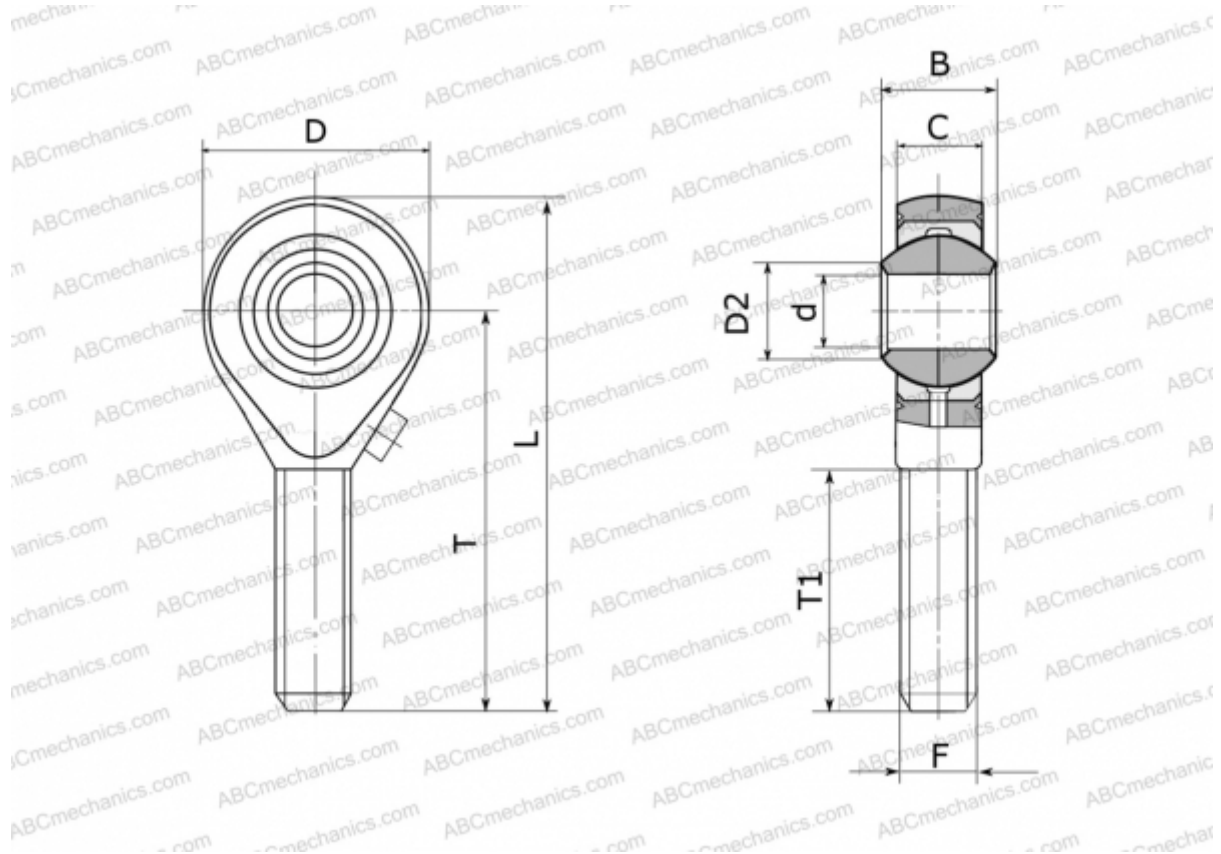

Technical specification

DIMENSIONS, MM

d	40,000
D	90,000
D2	44,200
B	49,000
L	187,000
T	142,000
T1	78,000
C	35,000
F	M 42x2

WEIGHT, KG 2,550

MANUFACTURER [FLURO](#)