

## GALRS 3 FLURO

TYPE: Plain bearings, Spherical plain bearings and rod ends, Rod ends, Requiring maintenance, With external thread, open design, left hand thread, stainless steel, series GALRS (FLURO)

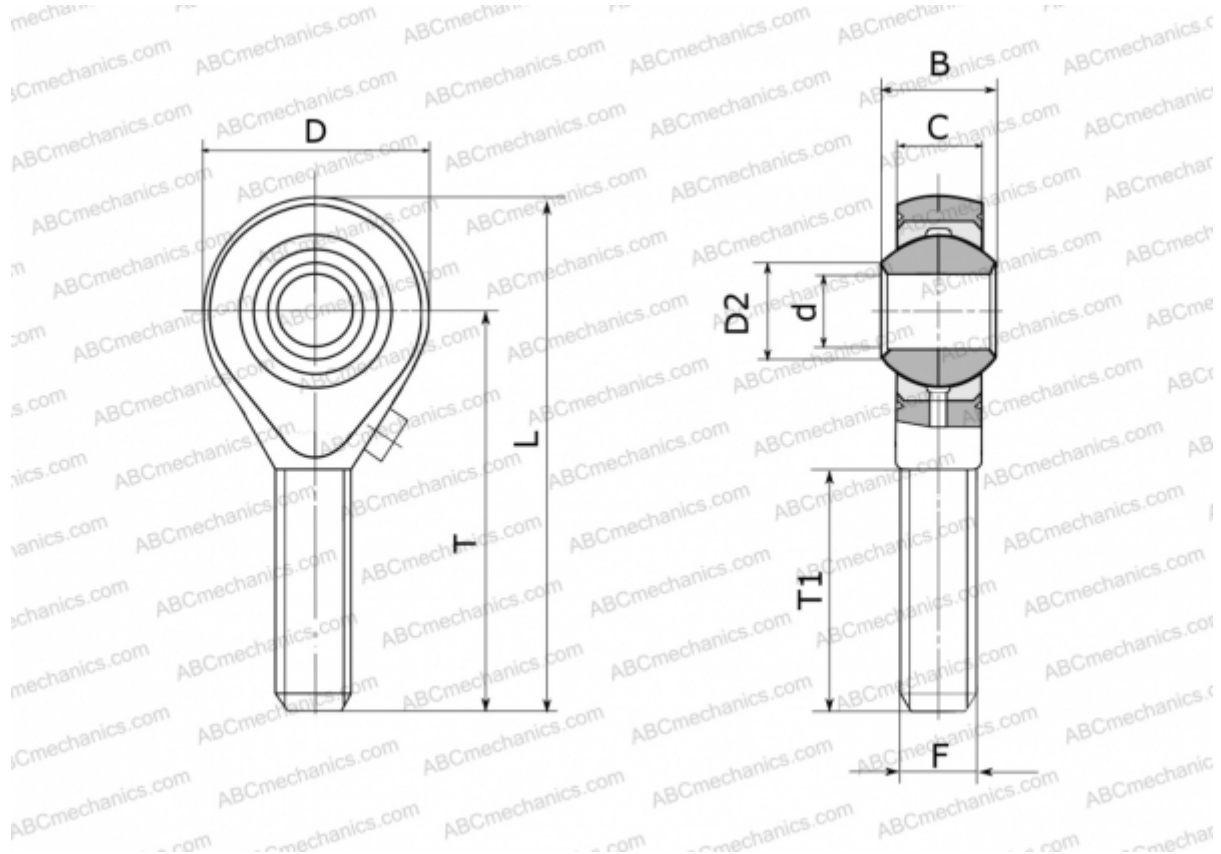

### Technical specification

#### DIMENSIONS, MM

d	3,000
D	14,000
D2	5,100
B	6,000
L	33,000
T	26,000
T1	15,000
C	4,500
F	M 3

**WEIGHT, KG** 0,006

**MANUFACTURER** [FLURO](#)