

## EGF08075-E40 INA

Plain bushes

TYPE: Plain bearings, Bushings, thrust washers and strips, Bushings, Flanged, Maintenance-free, with steel backing (INA)

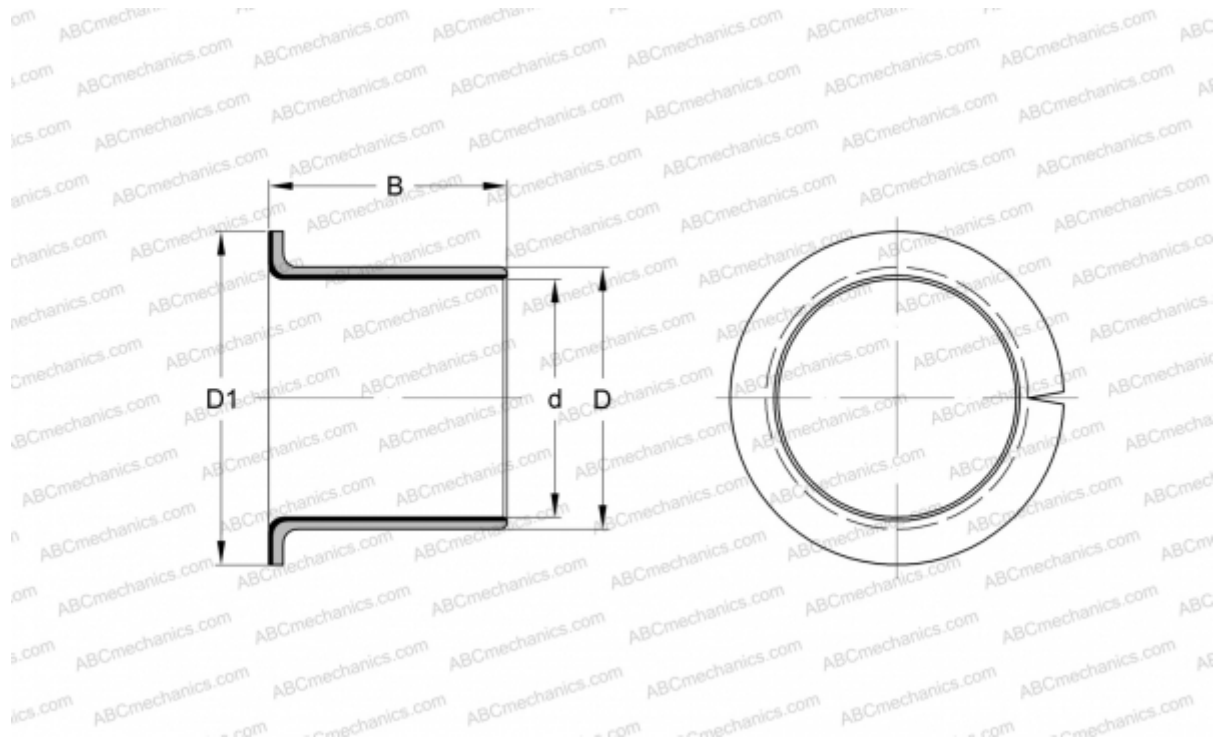

### Technical specification

#### DIMENSIONS, MM

d	8,000
D	10,000
D1	15,000
B	7,500

**WEIGHT, KG** 0,002

**MANUFACTURER** [INA](#)

#### REPLACES

PAF08075-P14