

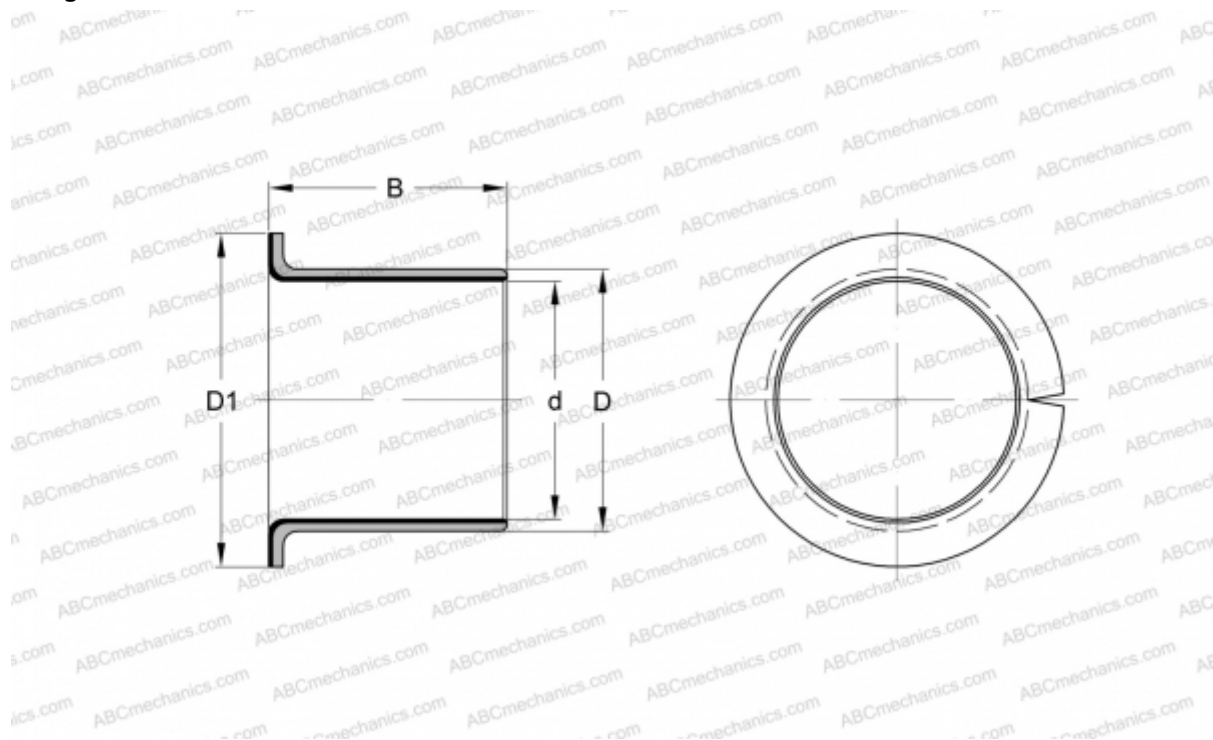

EGF10170-E40 INA

Plain bushes

TYPE: Plain bearings, Bushings, thrust washers and strips, Bushings, Flanged, Maintenance-free, with steel backing (INA)



Technical specification

DIMENSIONS, MM

d	10,000
D	12,000
D1	18,000
B	17,000

WEIGHT, KG 0,005

MANUFACTURER [INA](#)

REPLACES

PAF10170-P14

