

EGF18220-E40 INA

Plain bushes

TYPE: Plain bearings, Bushings, thrust washers and strips, Bushings, Flanged, Maintenance-free, with steel backing (INA)

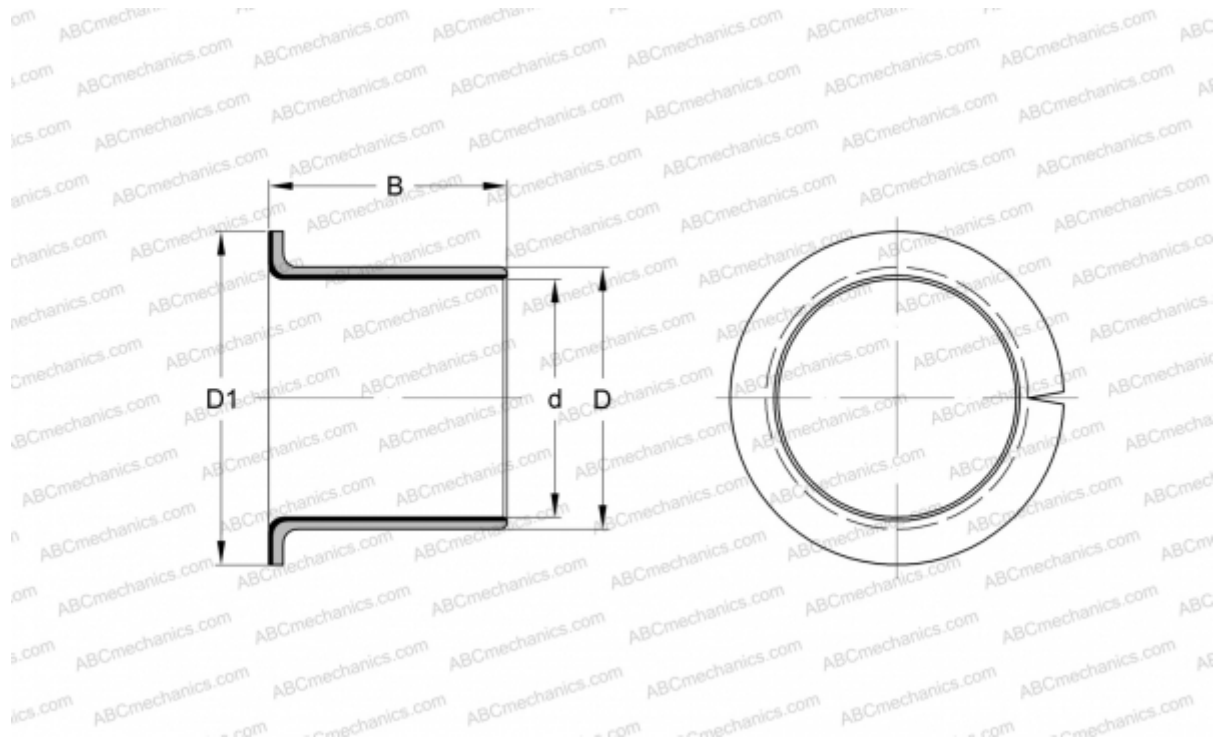

Technical specification

DIMENSIONS, MM

d	18,000
D	20,000
D1	26,000
B	22,000

WEIGHT, KG 0,011

MANUFACTURER [INA](#)

REPLACES

PAF18220-P14