

EGF20215-E40 INA

Plain bushes

TYPE: Plain bearings, Bushings, thrust washers and strips, Bushings, Flanged, Maintenance-free, with steel backing (INA)

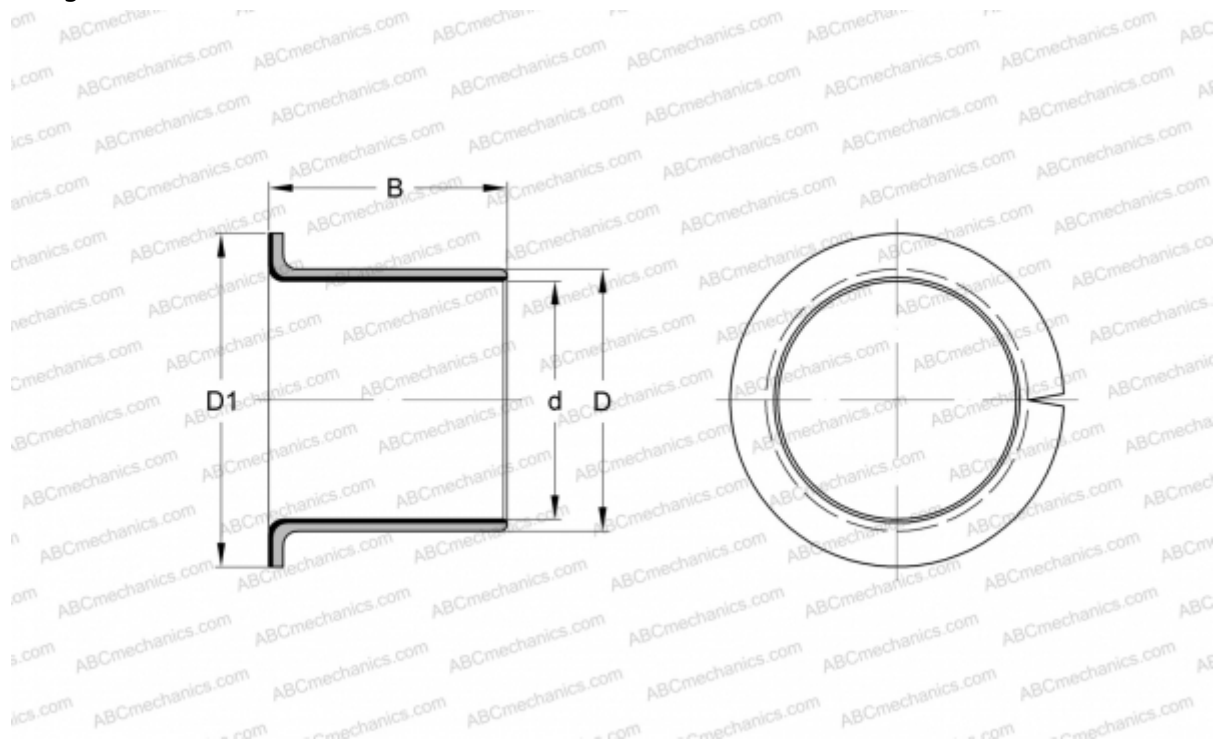

Technical specification

DIMENSIONS, MM

d	20,000
D	23,000
D1	30,000
B	21,500

WEIGHT, KG 0,019

MANUFACTURER [INA](#)

REPLACES

PAF20215-P14