

## EGF30260-E40 INA

Plain bushes

TYPE: Plain bearings, Bushings, thrust washers and strips, Bushings, Flanged, Maintenance-free, with steel backing (INA)

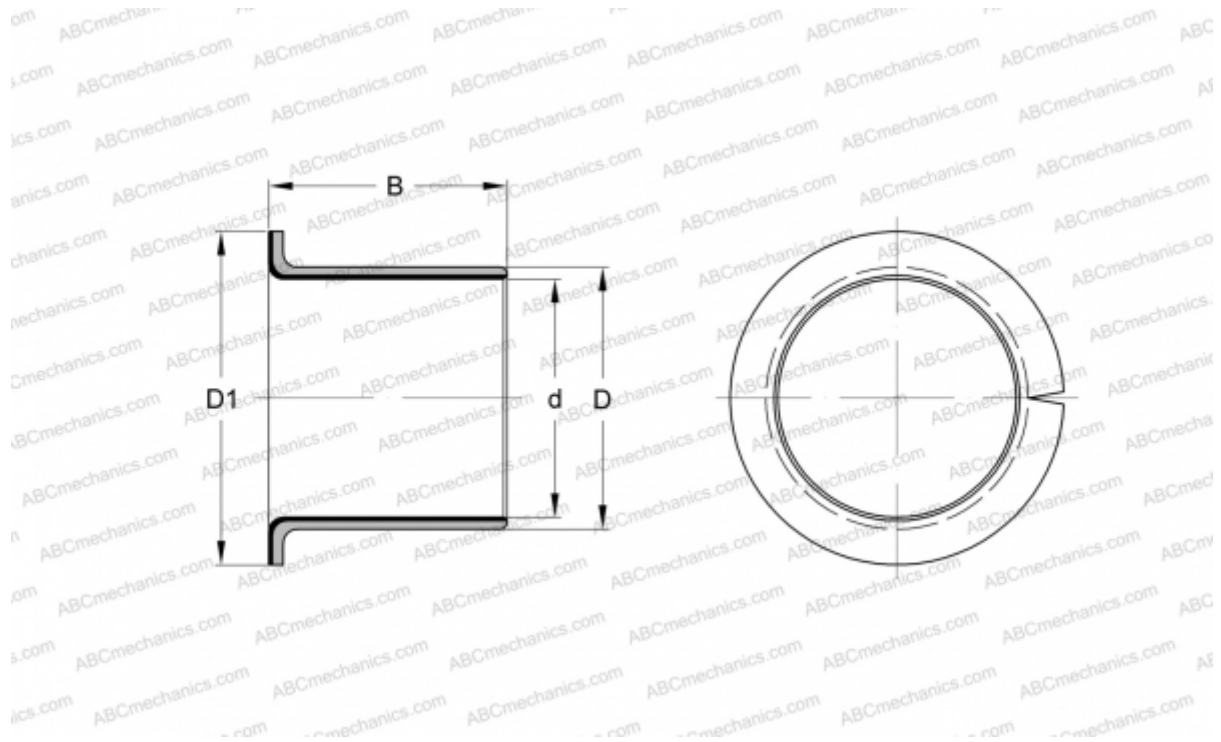

### Technical specification

#### DIMENSIONS, MM

d	30,000
D	34,000
D1	42,000
B	26,000

**WEIGHT, KG** 0,044

**MANUFACTURER** [INA](#)

#### REPLACES

PAF30260-P14