

## EGF35160-E40 INA

Plain bushes

TYPE: Plain bearings, Bushings, thrust washers and strips, Bushings, Flanged, Maintenance-free, with steel backing (INA)

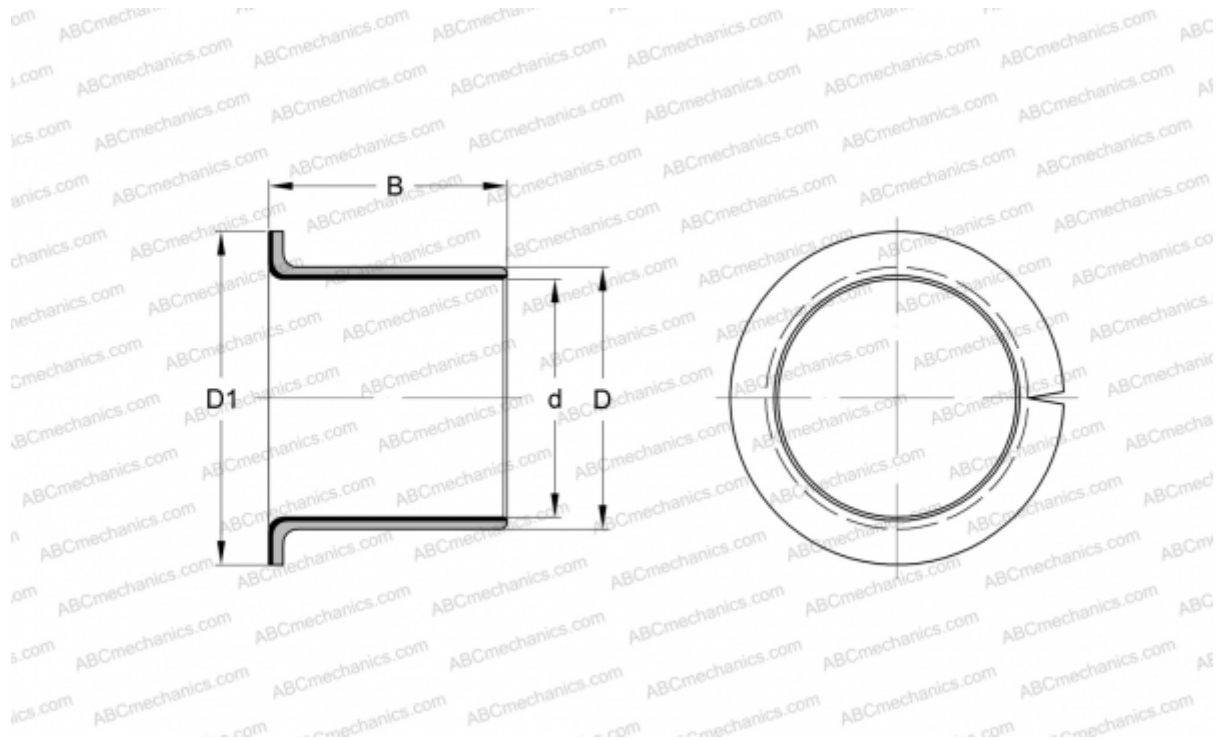

### Technical specification

#### DIMENSIONS, MM

d	35,000
D	39,000
D1	47,000
B	16,000

**WEIGHT, KG** 0,034

**MANUFACTURER** [INA](#)

#### REPLACES

PAF35160-P14