

EGF35260-E40 INA

Plain bushes

TYPE: Plain bearings, Bushings, thrust washers and strips, Bushings, Flanged, Maintenance-free, with steel backing (INA)

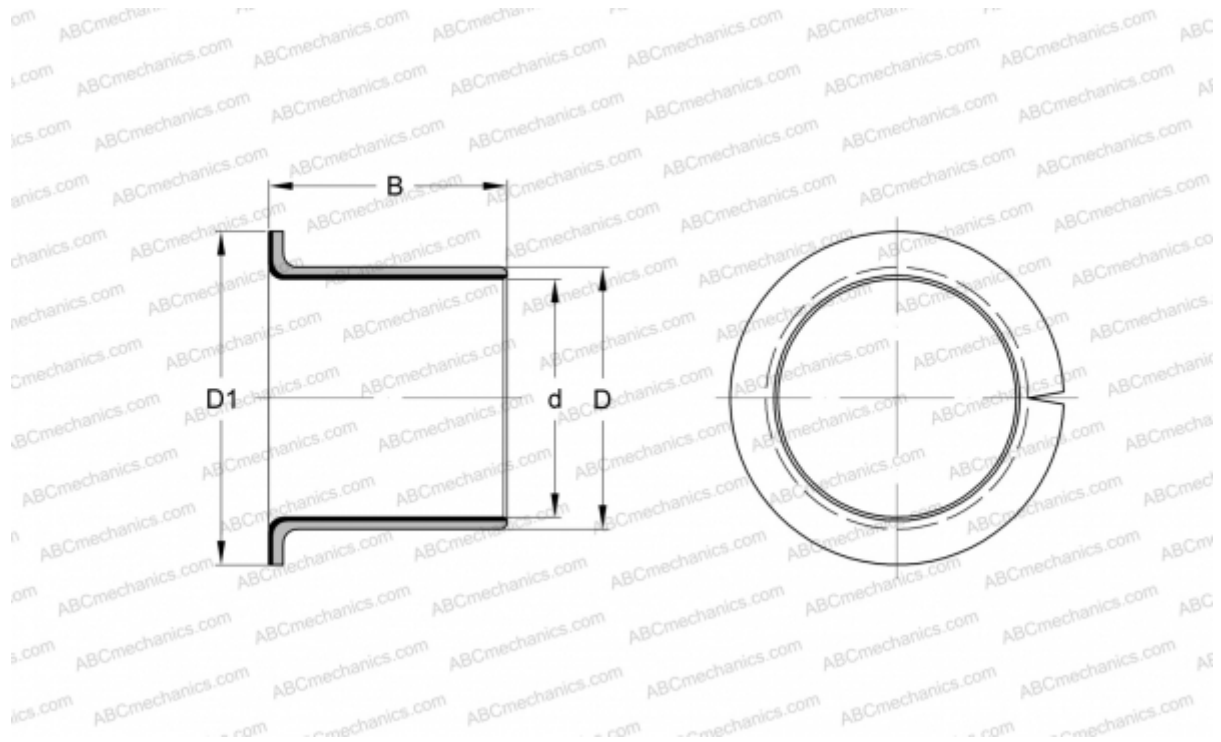

Technical specification

DIMENSIONS, MM

d	35,000
D	39,000
D1	47,000
B	26,000

WEIGHT, KG 0,051

MANUFACTURER [INA](#)

REPLACES

PAF35260-P14