

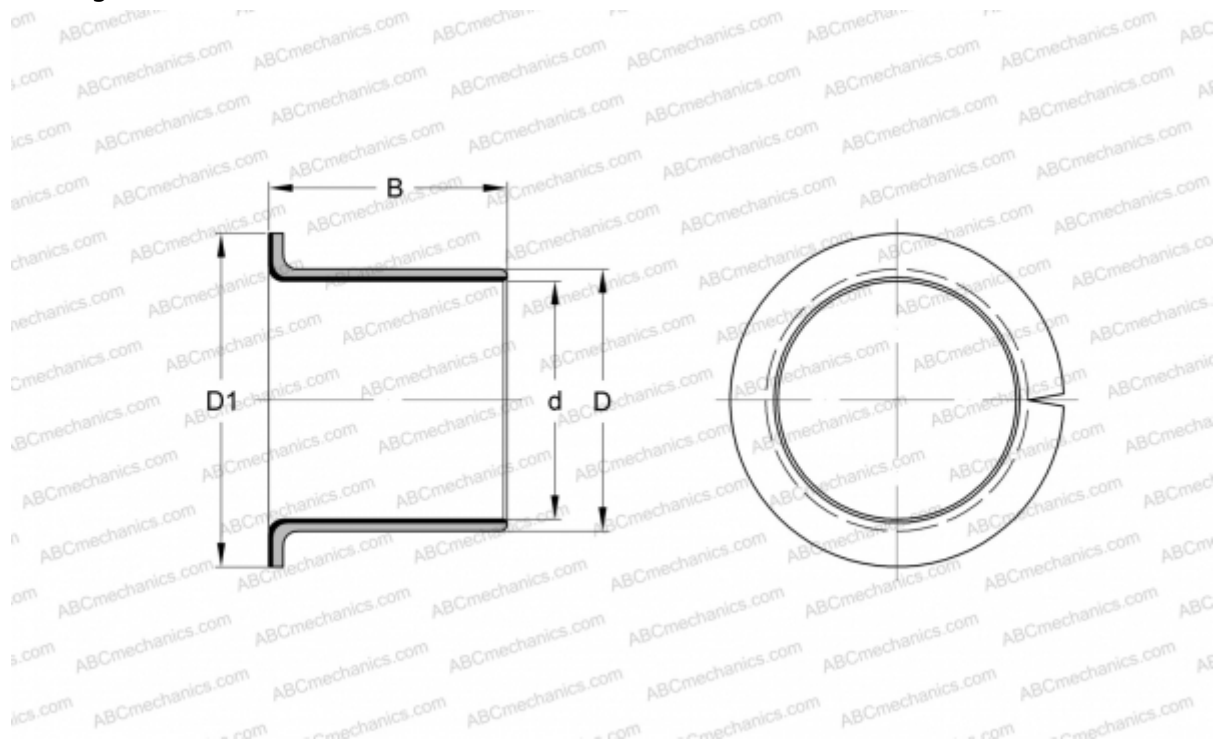

EGF06080-E40-B INA

Plain bushes

TYPE: Plain bearings, Bushings, thrust washers and strips, Bushings, Flanged, Maintenance-free, with bronze backing (INA)



Technical specification

DIMENSIONS, MM

d	6,000
D	8,000
D1	12,000
B	8,000

WEIGHT, KG 0,002

MANUFACTURER [INA](#)

REPLACES

PAF06080-P11

