

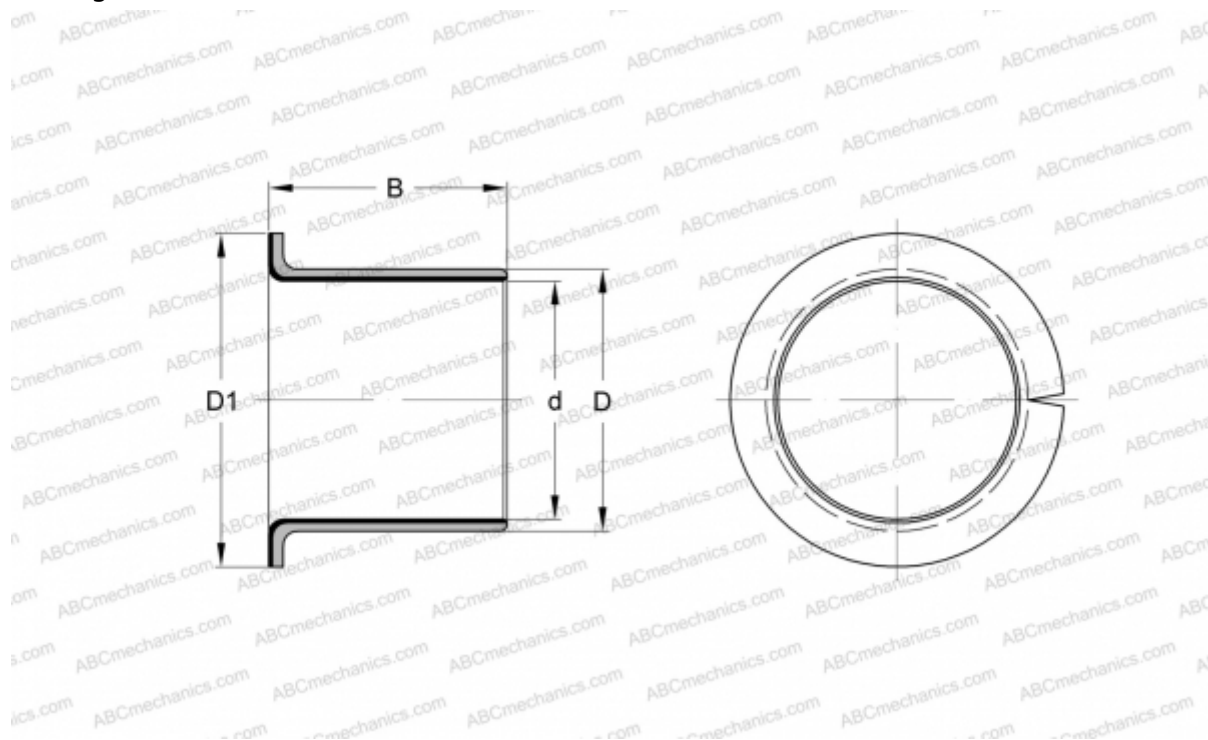

EGF08055-E40-B INA

Plain bushes

TYPE: Plain bearings, Bushings, thrust washers and strips, Bushings, Flanged, Maintenance-free, with bronze backing (INA)



Technical specification

DIMENSIONS, MM

| | |
|----|--------|
| d | 8,000 |
| D | 10,000 |
| D1 | 15,000 |
| B | 5,500 |

WEIGHT, KG 0,002

MANUFACTURER [INA](#)

REPLACES

PAF08055-P11

