

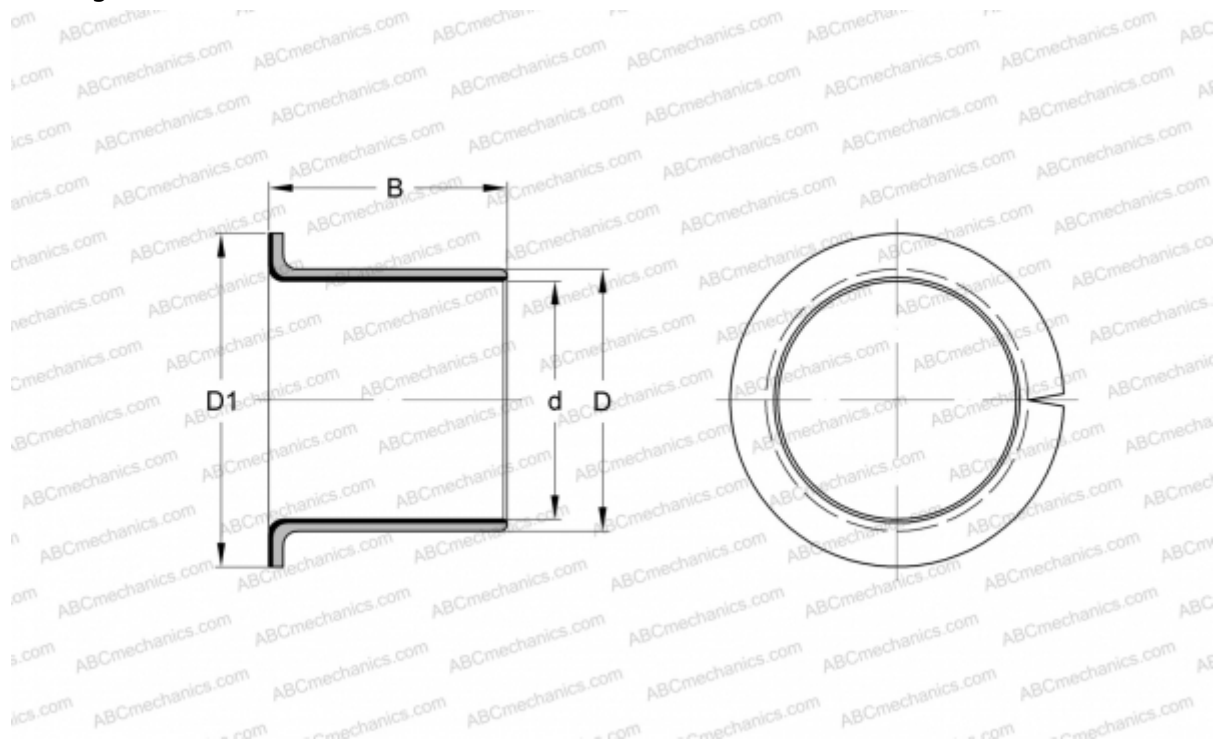

## EGF10170-E40-B INA

Plain bushes

TYPE: Plain bearings, Bushings, thrust washers and strips, Bushings, Flanged, Maintenance-free, with bronze backing (INA)



### Technical specification

#### DIMENSIONS, MM

d	10,000
D	12,000
D1	18,000
B	17,000

**WEIGHT, KG** 0,006

**MANUFACTURER** [INA](#)

#### REPLACES

PAF10170-P11

