

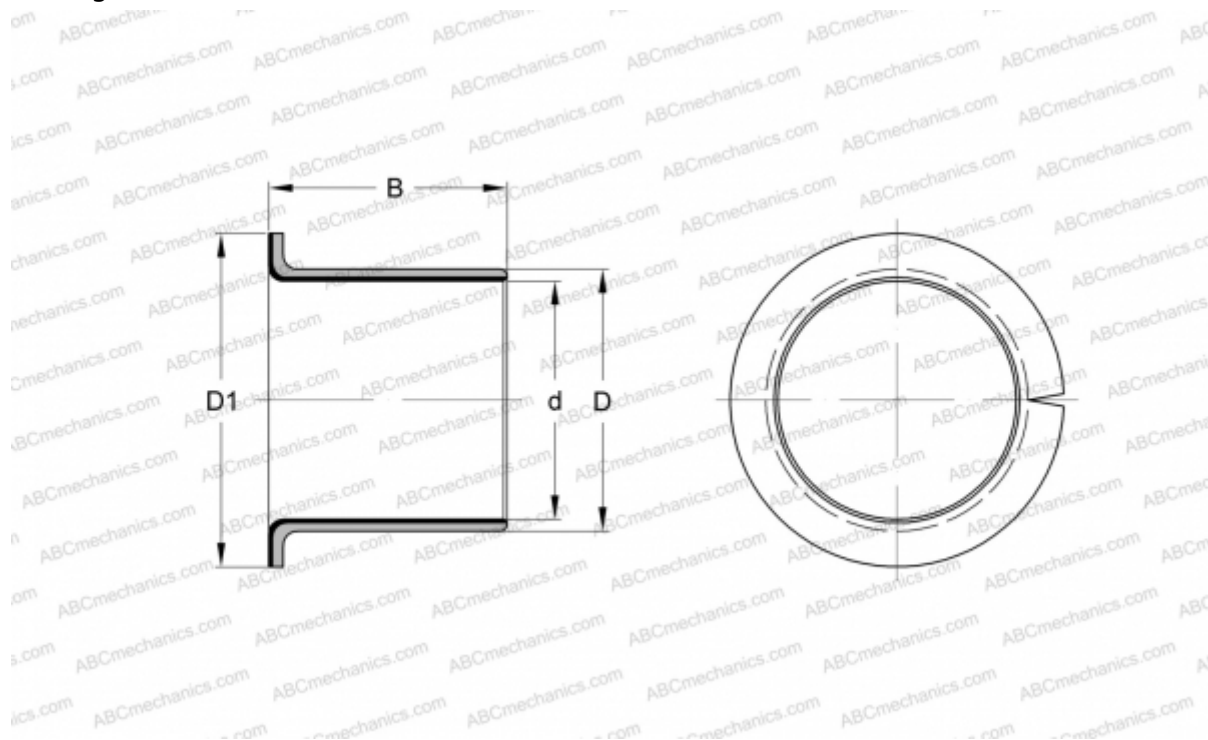

EGF12120-E40-B INA

Plain bushes

TYPE: Plain bearings, Bushings, thrust washers and strips, Bushings, Flanged, Maintenance-free, with bronze backing (INA)



Technical specification

DIMENSIONS, MM

d	12,000
D	14,000
D1	20,000
B	12,000

WEIGHT, KG 0,005

MANUFACTURER [INA](#)

REPLACES

PAF12120-P11

