

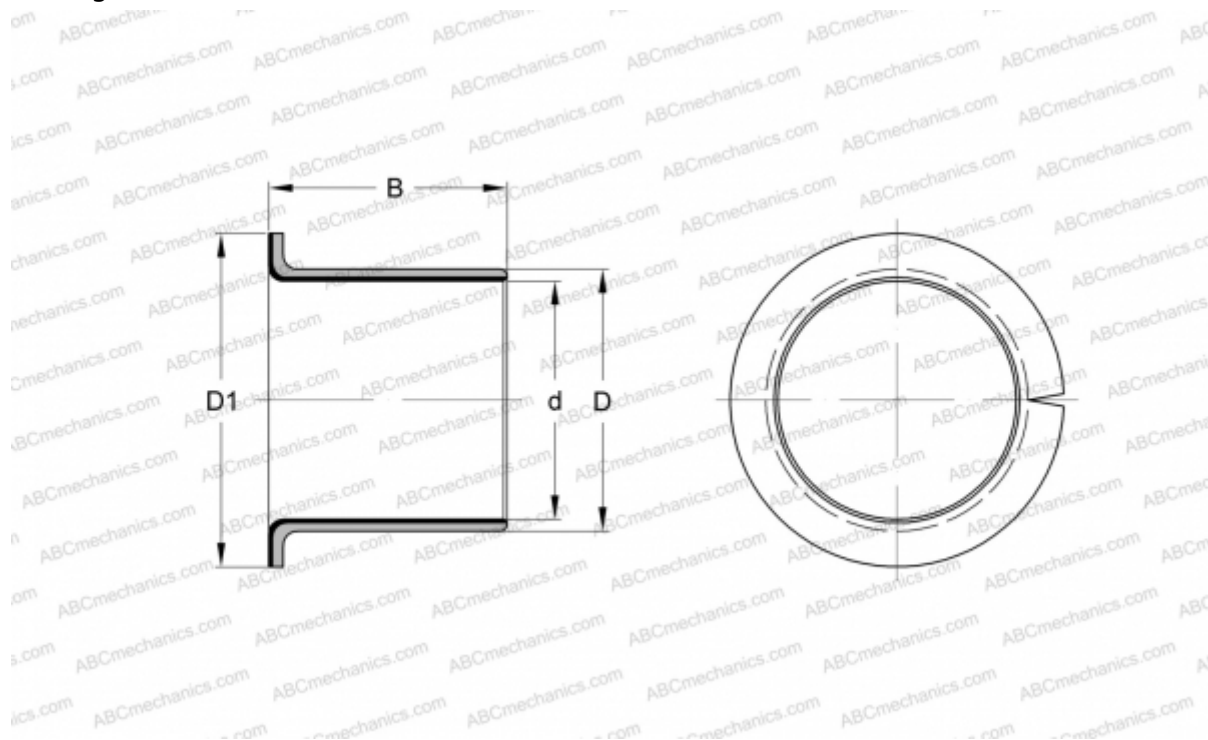

EGF18100-E40-B INA

Plain bushes

TYPE: Plain bearings, Bushings, thrust washers and strips, Bushings, Flanged, Maintenance-free, with bronze backing (INA)



Technical specification

DIMENSIONS, MM

d	18,000
D	20,000
D1	26,000
B	10,000

WEIGHT, KG 0,006

MANUFACTURER [INA](#)

REPLACES

PAF18100-P11

