

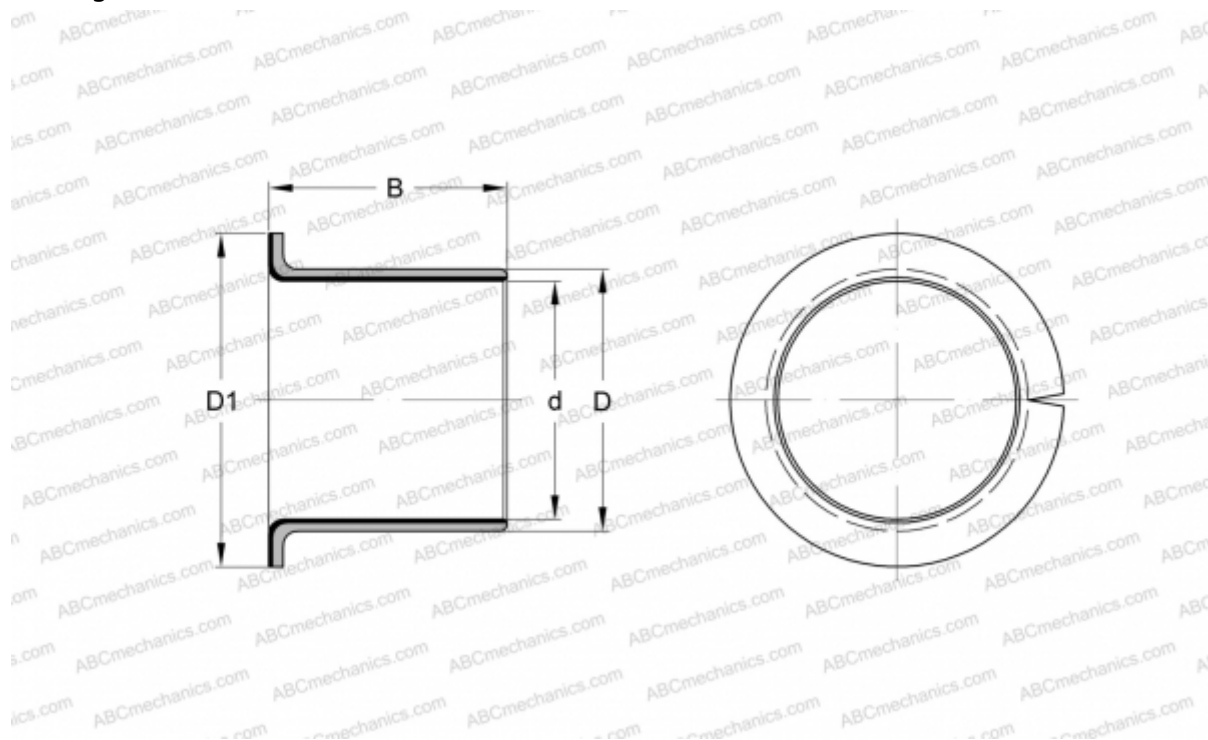

## EGF20165-E40-B INA

Plain bushes

TYPE: Plain bearings, Bushings, thrust washers and strips, Bushings, Flanged, Maintenance-free, with bronze backing (INA)



### Technical specification

#### DIMENSIONS, MM

d	20,000
D	23,000
D1	30,000
B	16,500

**WEIGHT, KG** 0,016

**MANUFACTURER** [INA](#)

#### REPLACES

PAF20165-P11

