

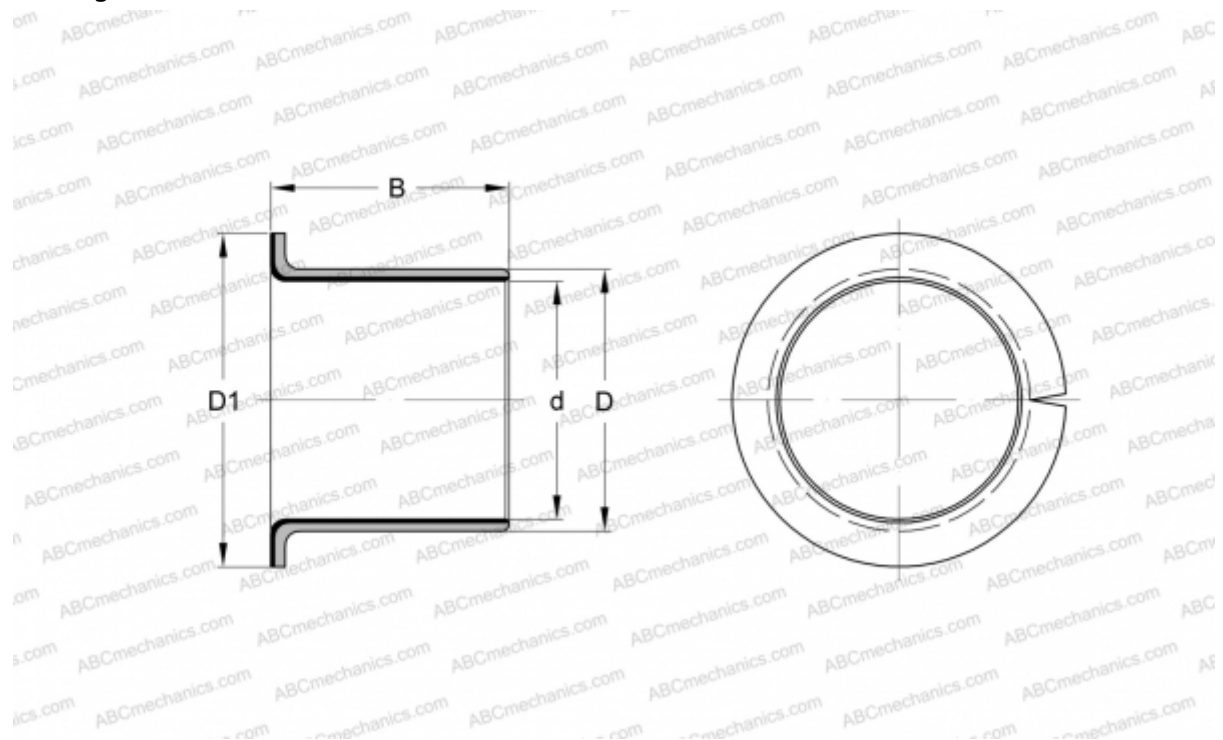

EGF25215-E40-B INA

Plain bushes

TYPE: Plain bearings, Bushings, thrust washers and strips, Bushings, Flanged, Maintenance-free, with bronze backing (INA)



Technical specification

DIMENSIONS, MM

d	25,000
D	28,000
D1	35,000
B	21,500

WEIGHT, KG 0,025

MANUFACTURER [INA](#)

REPLACES

PAF25215-P11

