

PCMF 151709 E SKF

Plain bushes

TYPE: Plain bearings, Bushings, thrust washers and strips, Bushings, Flanged, Maintenance-free, PTFE composite (SKF)

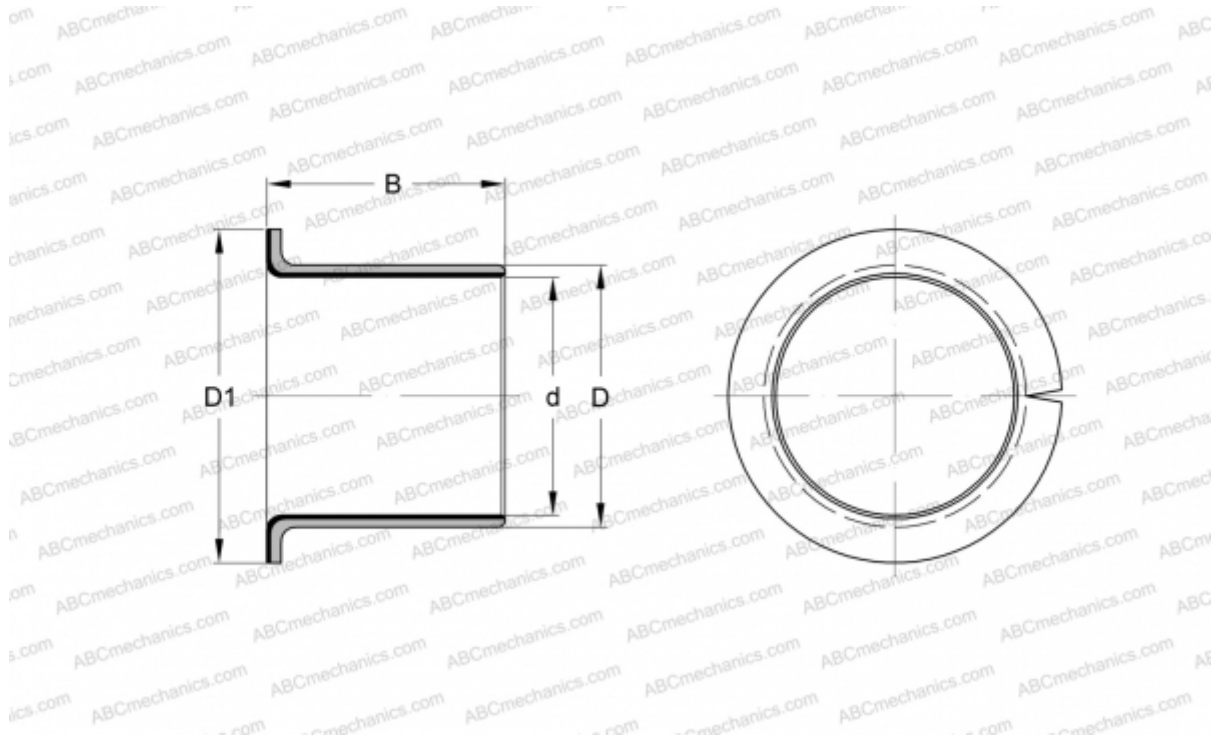

Technical specification

DIMENSIONS, MM

d	15,000
D	17,000
D1	23,000
B	9,000

WEIGHT, KG 0,005

MANUFACTURER [SKF](#)

REPLACES

PCMF151709B