

PCMF 161817 E SKF

Plain bushes

TYPE: Plain bearings, Bushings, thrust washers and strips, Bushings, Flanged, Maintenance-free, PTFE composite (SKF)

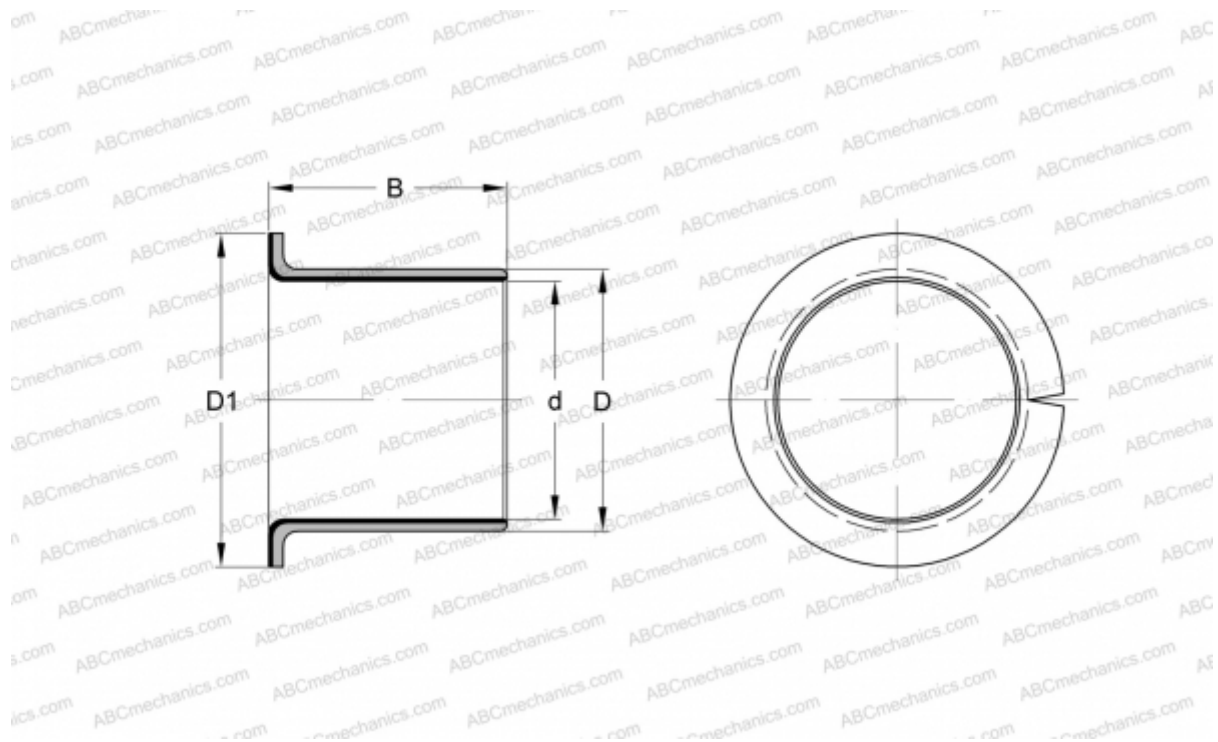

Technical specification

DIMENSIONS, MM

d	16,000
D	18,000
D1	24,000
B	17,000

WEIGHT, KG 0,008

MANUFACTURER [SKF](#)

REPLACES

PCMF161817B