

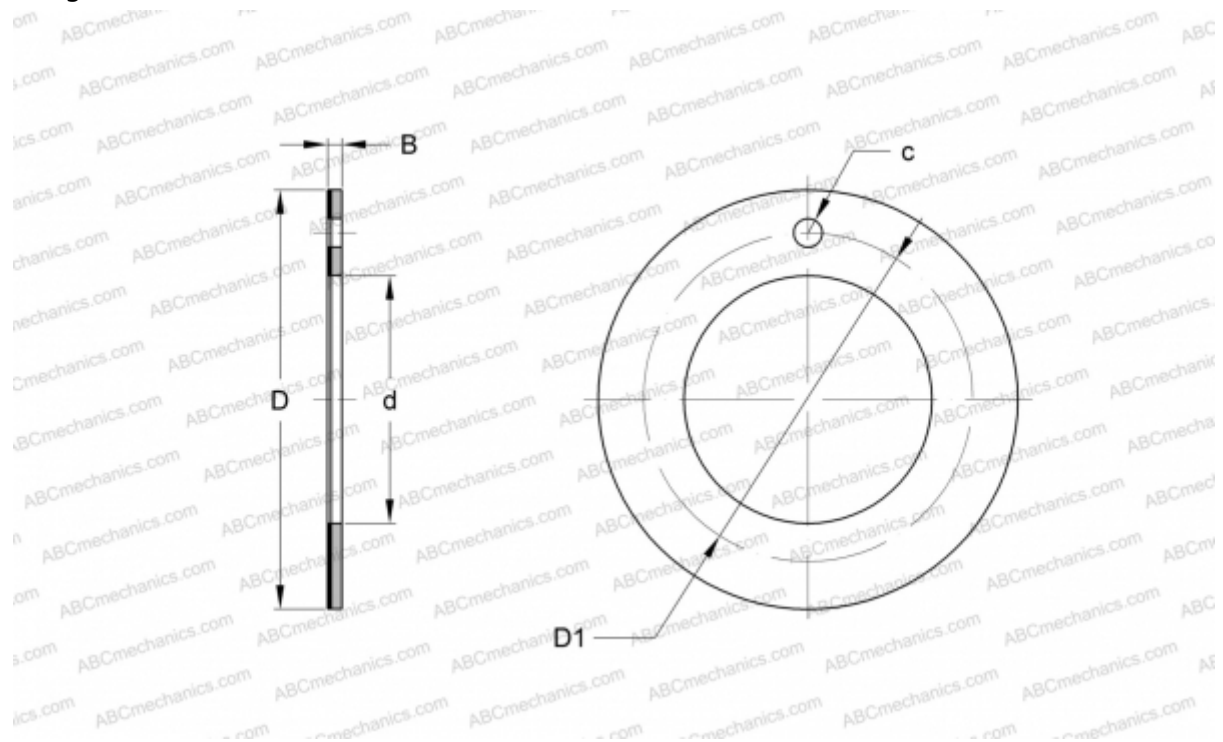

EGW12-E40 INA

Thrust washers

TYPE: Plain bearings, Bushings, thrust washers and strips, Thrust washers, Maintenance-free, with steel backing (INA)



Technical specification

DIMENSIONS, MM

d	12,000
D	24,000
D1	18,000
B	1,500
c	1,500

WEIGHT, KG 0,004

MANUFACTURER [INA](#)

REPLACES

PAW12-P14

