

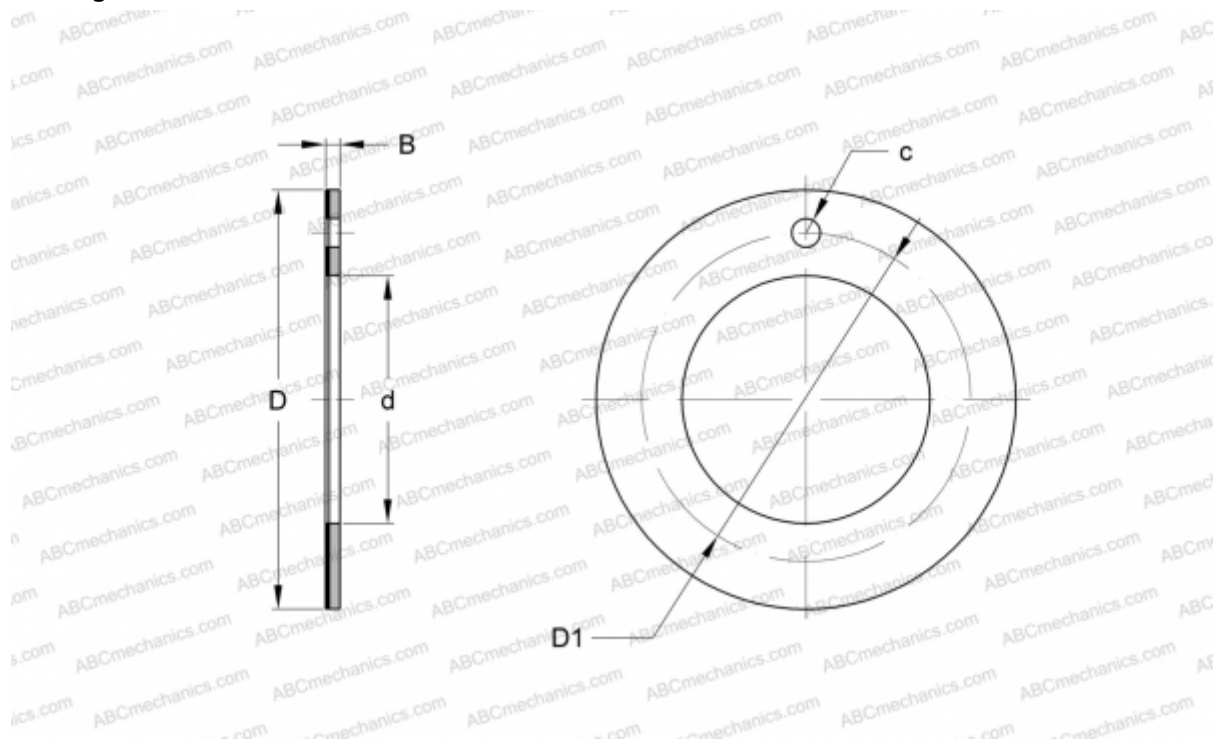

EGW42-E40-B INA

Thrust washers

TYPE: Plain bearings, Bushings, thrust washers and strips, Thrust washers, Maintenance-free, with bronze backing (INA)



Technical specification

DIMENSIONS, MM

d	42,000
D	66,000
D1	54,000
B	1,500
c	4,000

WEIGHT, KG 0,025

MANUFACTURER [INA](#)

REPLACES

PAW42-P11

