

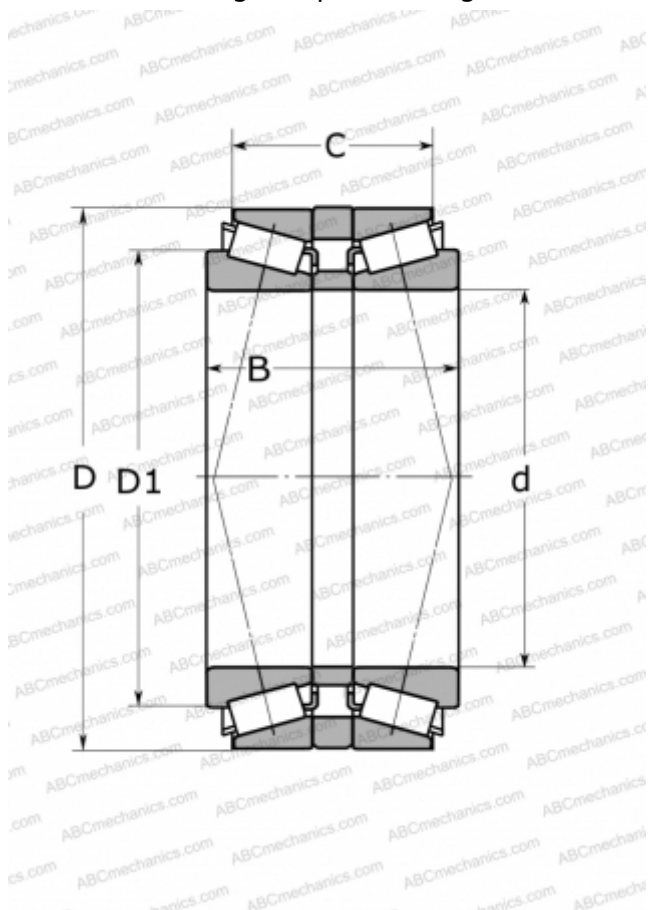

31318T103 J2/DB31 SKF

Tapered roller bearings

TYPE: Roller bearings, Tapered, Single row, matched bearings, Back-to-back (SKF)



Technical specification

DIMENSIONS, MM

d	90,000
D	190,000
D1	138,000
B	103,000
C	70,000

WEIGHT, KG

12,500

MANUFACTURER

[SKF](#)

CALCULATION DATA

Basic dynamic load rating, C	457,000 kN
Basic static load rating, Co	630,000 kN
Fatigue load limit, Pu	73,500 kN
Reference speed	1900 r/min
Limiting speed	3400 r/min

