

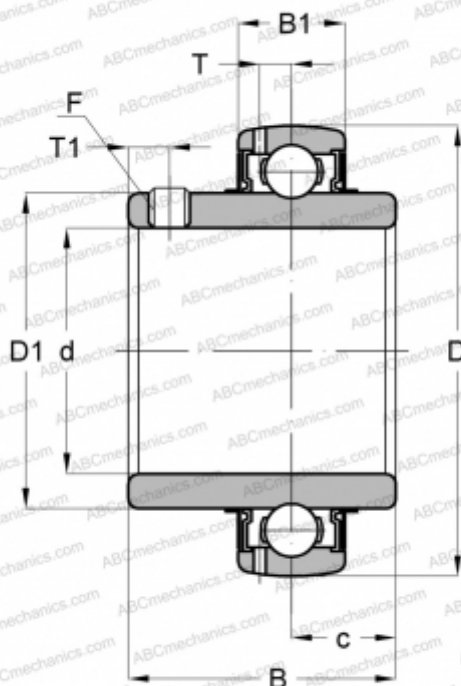

YAR 215-2F SKF

Insert bearings

TYPE: Ball bearings, Radial insert bearings, Grub screw to inner ring, Spherical outer ring, Series YAR, NBR contact seal and additional plain flinger on both sides (SKF)



Technical specification

DIMENSIONS, MM

d	75,000
D	130,000
D1	92,000
B	73,300
C	29,000

WEIGHT, KG

2,100

MANUFACTURER

[SKF](#)

CALCULATION DATA

Basic dynamic load rating, C	66,300 kN
Basic static load rating, Co	49,000 kN
Fatigue load limit, Pu	2,040 kN
Limiting speed	2600 r/min

