

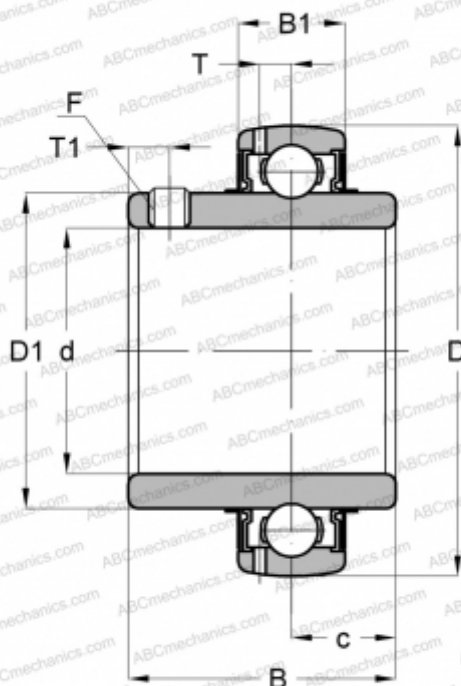

YAR 220-2F SKF

Insert bearings

TYPE: Ball bearings, Radial insert bearings, Grub screw to inner ring, Spherical outer ring, Series YAR, NBR contact seal and additional plain flinger on both sides (SKF)



Technical specification

DIMENSIONS, MM

d	100,000
D	180,000
D1	124,000
B	98,400
C	40,000

WEIGHT, KG

5,350

MANUFACTURER

[SKF](#)

CALCULATION DATA

Basic dynamic load rating, C	124,000 kN
Basic static load rating, Co	93,000 kN
Fatigue load limit, Pu	3,350 kN
Limiting speed	1900 r/min

