

## YET 205 SKF

Insert bearings

TYPE: Ball bearings, Radial insert bearings, With eccentric locking collar, Spherical outer ring, Series YET (SKF)

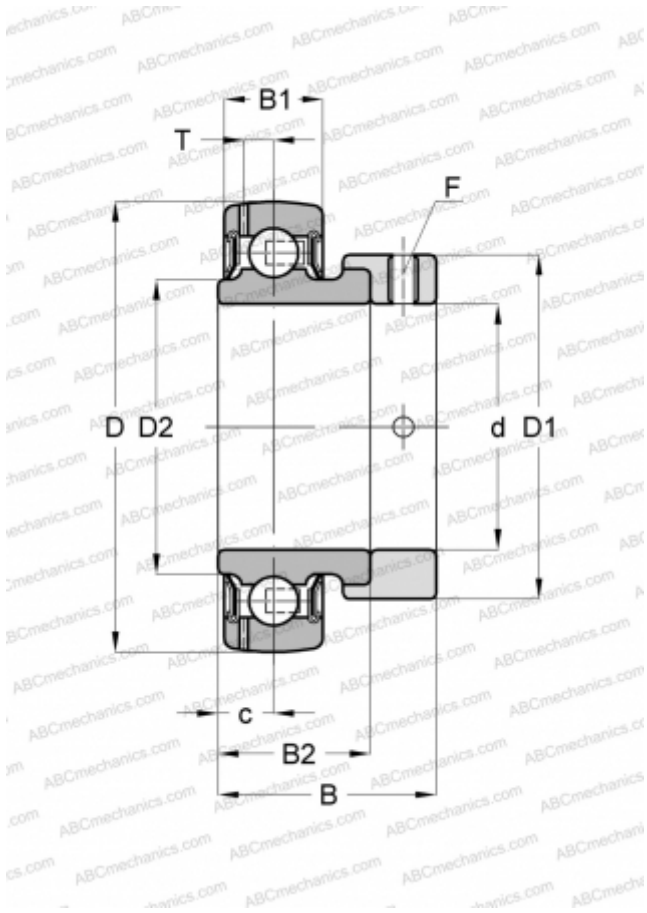

### Technical specification

#### DIMENSIONS, MM

$d$	25,000
$D$	52,000
$D1$	37,400
$D2$	33,700
$B$	31,000
$B1$	15,000
$B2$	21,500

#### WEIGHT, KG

0,180

#### MANUFACTURER

[SKF](#)

#### CALCULATION DATA

Basic dynamic load rating, $C$	14,000 kN
Basic static load rating, $C_0$	7,800 kN
Fatigue load limit, $P_u$	0,335 kN
Limiting speed	7000 r/min