

## E2.YET 207-107 SKF

Insert bearings

TYPE: Ball bearings, Radial insert bearings, With eccentric locking collar, Spherical outer ring, Series YET, Energy Efficient bearing, inch (SKF)

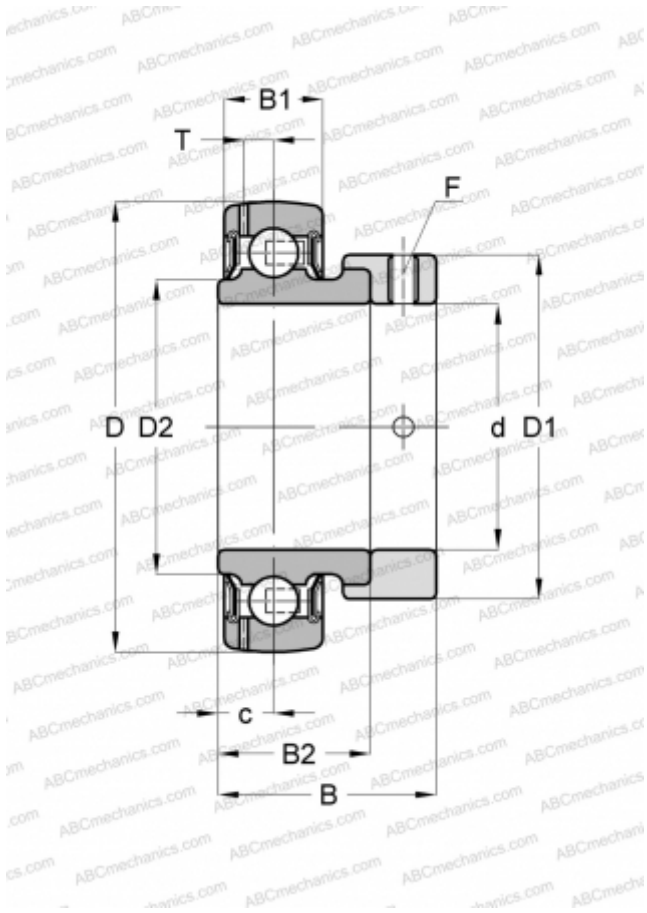

### Technical specification

#### DIMENSIONS, MM

d	36,513
D	72,000
D1	51,100
D2	46,100
B	38,900
B1	19,000
B2	25,400

#### WEIGHT, KG

0,400

#### MANUFACTURER

[SKF](#)

#### CALCULATION DATA

Basic dynamic load rating, C	25,500 kN
Basic static load rating, Co	15,300 kN
Fatigue load limit, Pu	0,655 kN
Limiting speed	5300 r/min