

NATR 12 X SKF

Yoke type track roller

TYPE: Roller bearings, Yoke type track rollers, With axial guidance, Gap seals on both side, cylindrical outer ring

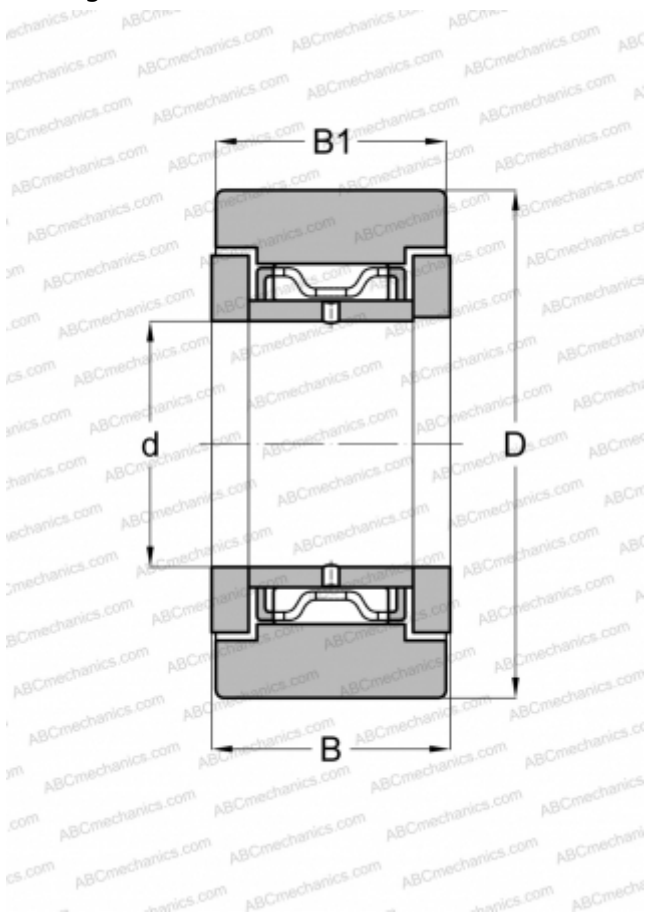

Technical specification

DIMENSIONS, MM

d	12,000
D	32,000
B	15,000
B1	14,000

WEIGHT, KG

0,071

MANUFACTURER

[SKF](#)

INTERCHANGE

ABC	NATR 12 X
FAG	NATR 12 DZ/ NATD 12 DZ
INA	NATR 12 X
McGill	MCYRR 12 SX

CALCULATION DATA

Basic dynamic load rating, C	6,600 kN
Basic static load rating, Co	8,500 kN
Fatigue load limit, Pu	0,950 kN
Limiting speed	4500 r/min