

MCFD 35 SX McGill

Cam followers

TYPE: Roller bearings, Stud type track rollers, With axial guidance, full complement cylindrical roller set, labyrinth seals on both sides, cylindrical outer ring

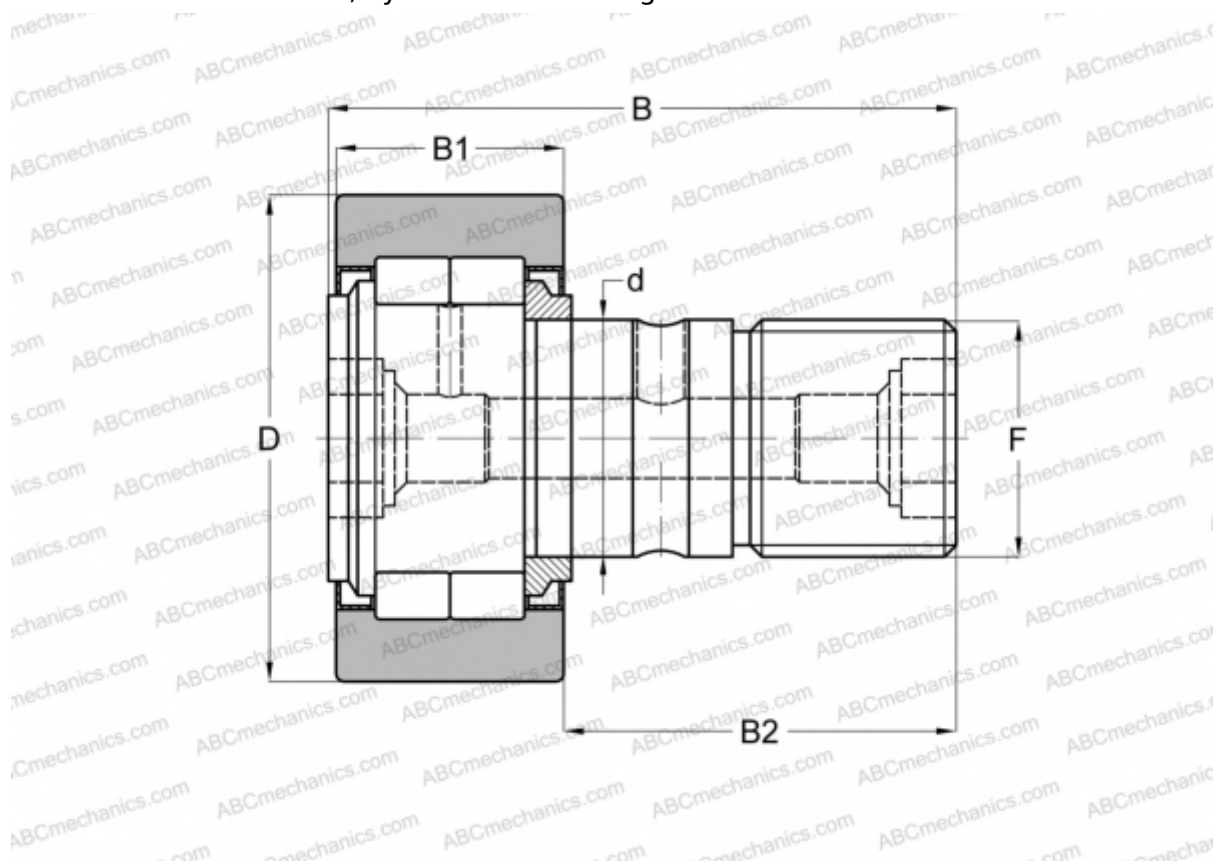

Technical specification

DIMENSIONS, MM

| | |
|----|---------|
| d | 16,000 |
| D | 35,000 |
| B | 52,000 |
| B1 | 18,000 |
| B2 | 32,500 |
| F | M16x1,5 |

WEIGHT, KG 0,172

MANUFACTURER [McGill](#)

INTERCHANGE

| | |
|-----|--|
| ABC | NUKR 35 X |
| FAG | NUKR 35 C DZ(NUKD35 AA DZ) |
| INA | NUKR 35 X |
| IKO | NUCF 16 |

INTERCHANGE

| | |
|-----|----------------------------|
| SKF | NUKR 35 XA |
|-----|----------------------------|