

NUKR 52 X ABC

Cam followers

TYPE: Roller bearings, Stud type track rollers, With axial guidance, full complement cylindrical roller set, labyrinth seals on both sides, cylindrical outer ring

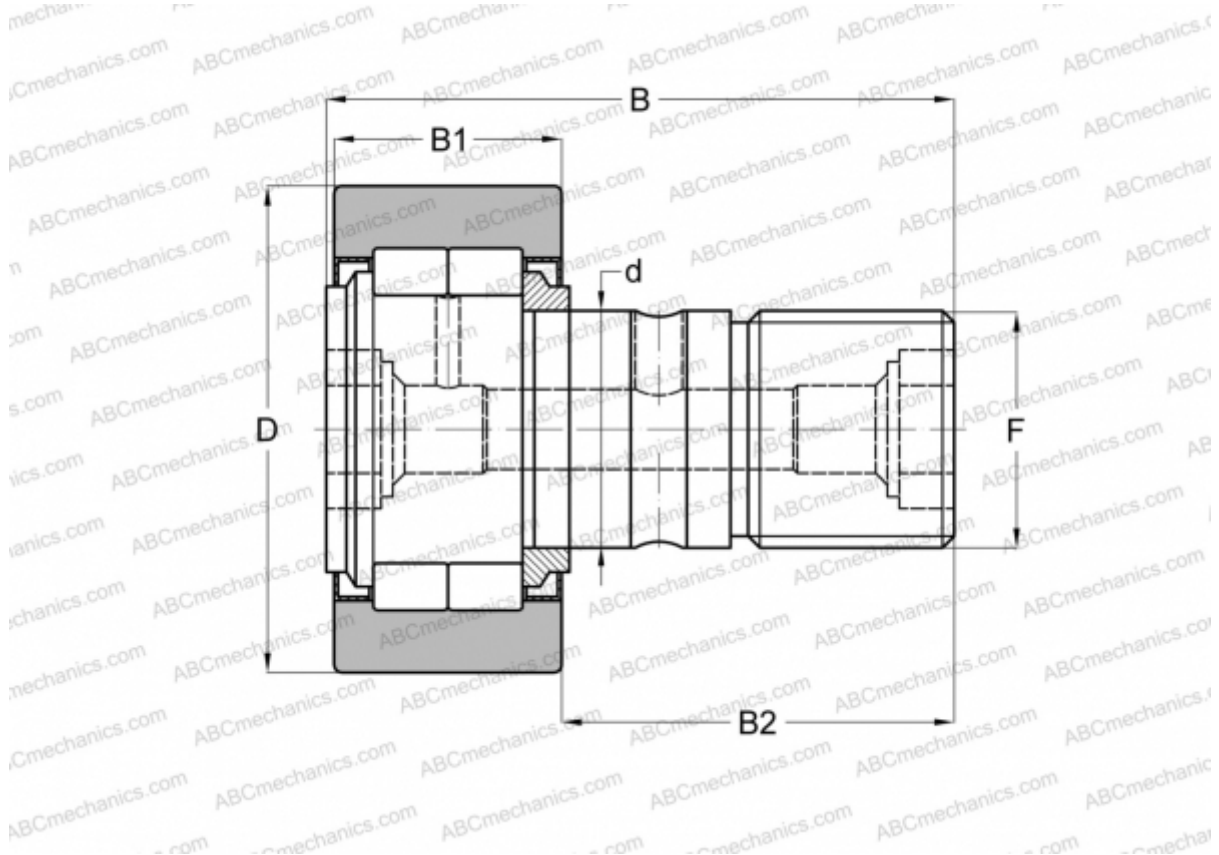

Technical specification

DIMENSIONS, MM

d	20,000
D	52,000
B	66,000
B1	24,000
B2	40,500
F	M20x1,5

WEIGHT, KG 0,463

MANUFACTURER [ABC](#)

INTERCHANGE

FAG	NUKR 52 C DZ(NUKD52 DZ)
INA	NUKR 52 X
IKO	NUCF 20
McGill	MCFD 52 SX

INTERCHANGE

SKF [NUKR 52 XA](#)