

## NUKR 72 X ABC

Cam followers

TYPE: Roller bearings, Stud type track rollers, With axial guidance, full complement cylindrical roller set, labyrinth seals on both sides, cylindrical outer ring

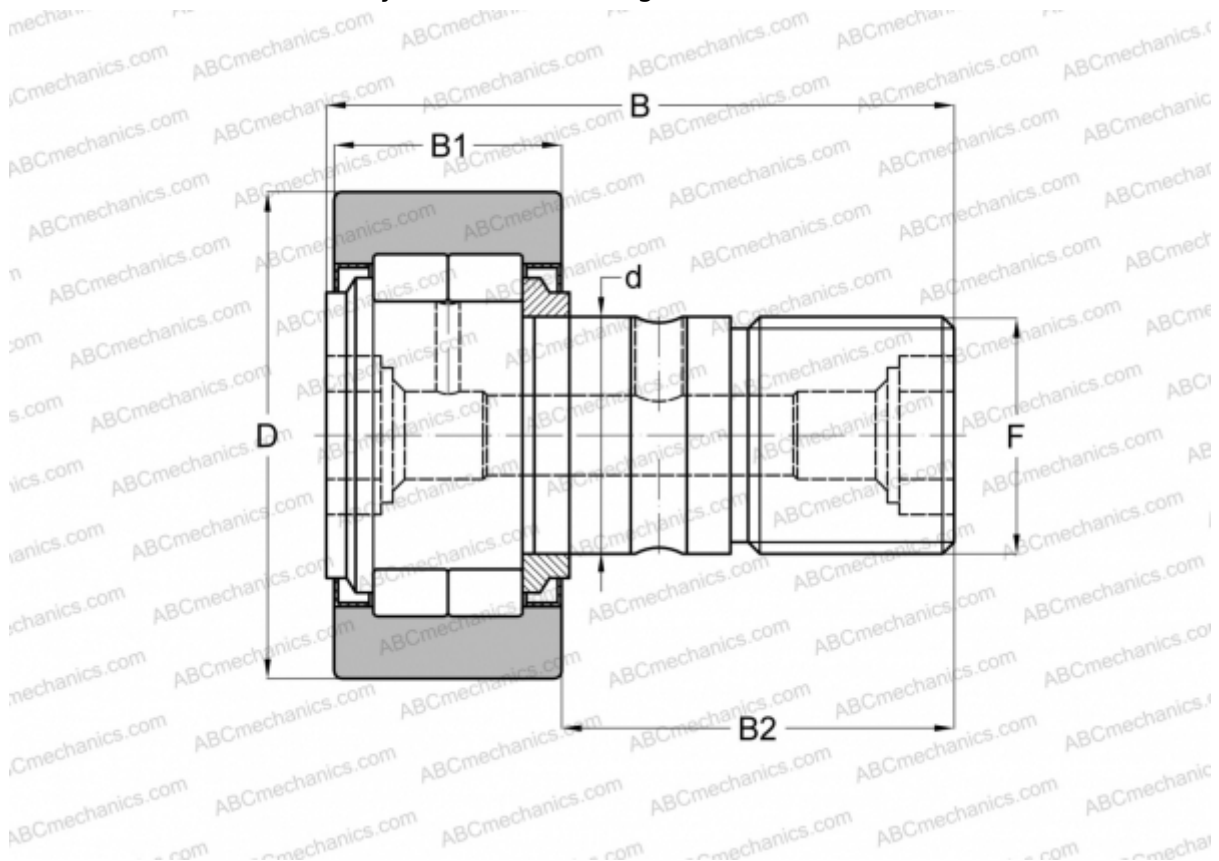

### Technical specification

#### DIMENSIONS, MM

d	24,000
D	72,000
B	80,000
B1	29,000
B2	49,500
F	M24x1,5

**WEIGHT, KG** 1,043

**MANUFACTURER** [ABC](#)

#### INTERCHANGE

FAG	<a href="#">NUKR 72 C DZ(NUKD72 DZ)</a>
INA	<a href="#">NUKR 72 X</a>
IKO	<a href="#">NUCF 24-1</a>
McGill	<a href="#">MCFD 72 SX</a>

#### INTERCHANGE

SKF [NUKR 72 XA](#)