

NUCF 24-1 IKO

Cam followers

TYPE: Roller bearings, Stud type track rollers, With axial guidance, full complement cylindrical roller set, labyrinth seals on both sides, cylindrical outer ring

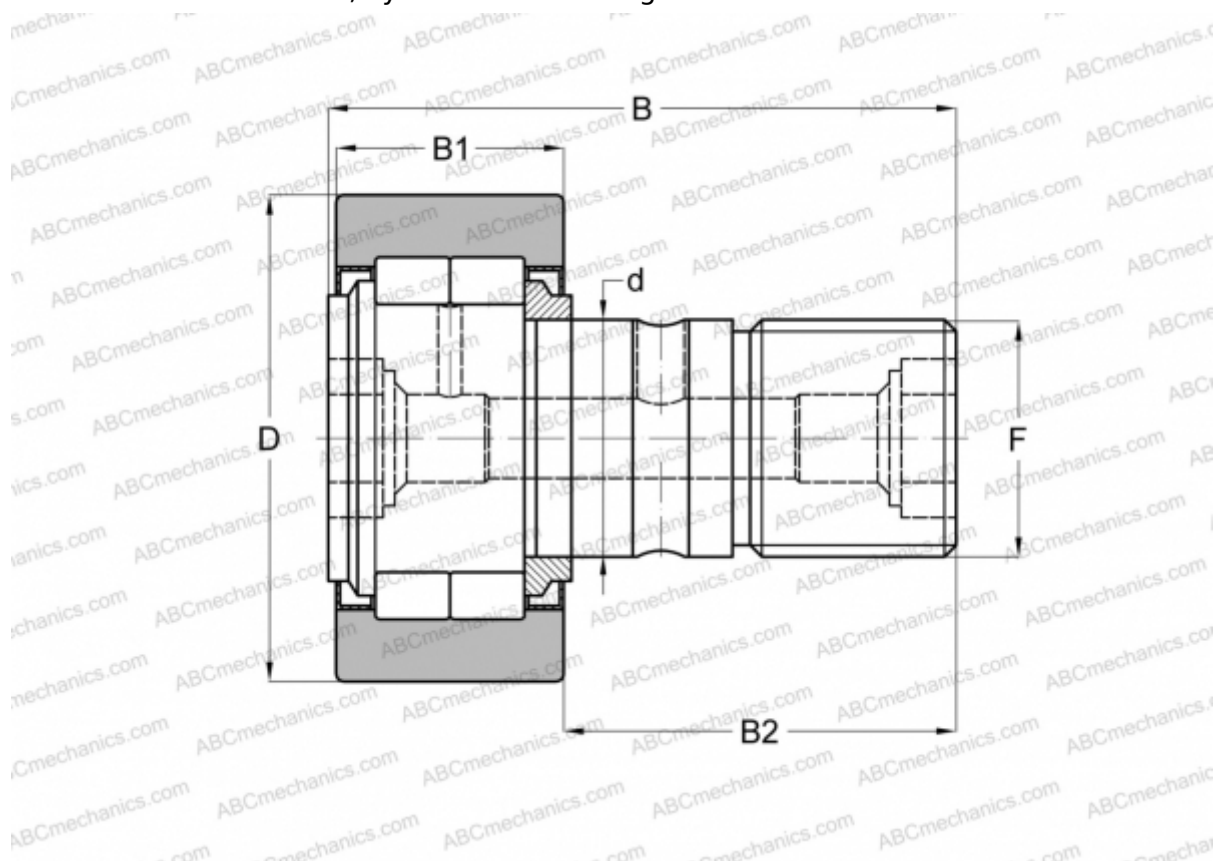

Technical specification

DIMENSIONS, MM

| | |
|----|---------|
| d | 24,000 |
| D | 72,000 |
| B | 80,000 |
| B1 | 29,000 |
| B2 | 49,500 |
| F | M24x1,5 |

WEIGHT, KG 1,043

MANUFACTURER [IKO](#)

INTERCHANGE

| | |
|--------|---|
| ABC | NUKR 72 X |
| FAG | NUKR 72 C DZ(NUKD72 DZ) |
| INA | NUKR 72 X |
| McGill | MCFD 72 SX |

INTERCHANGE

SKF [NUKR 72 XA](#)