

## NUKRE 72 ABC

Cam followers

TYPE: Roller bearings, Stud type track rollers, With axial guidance, full complement cylindrical roller set, with eccentric collar, labyrinth seals on both sides

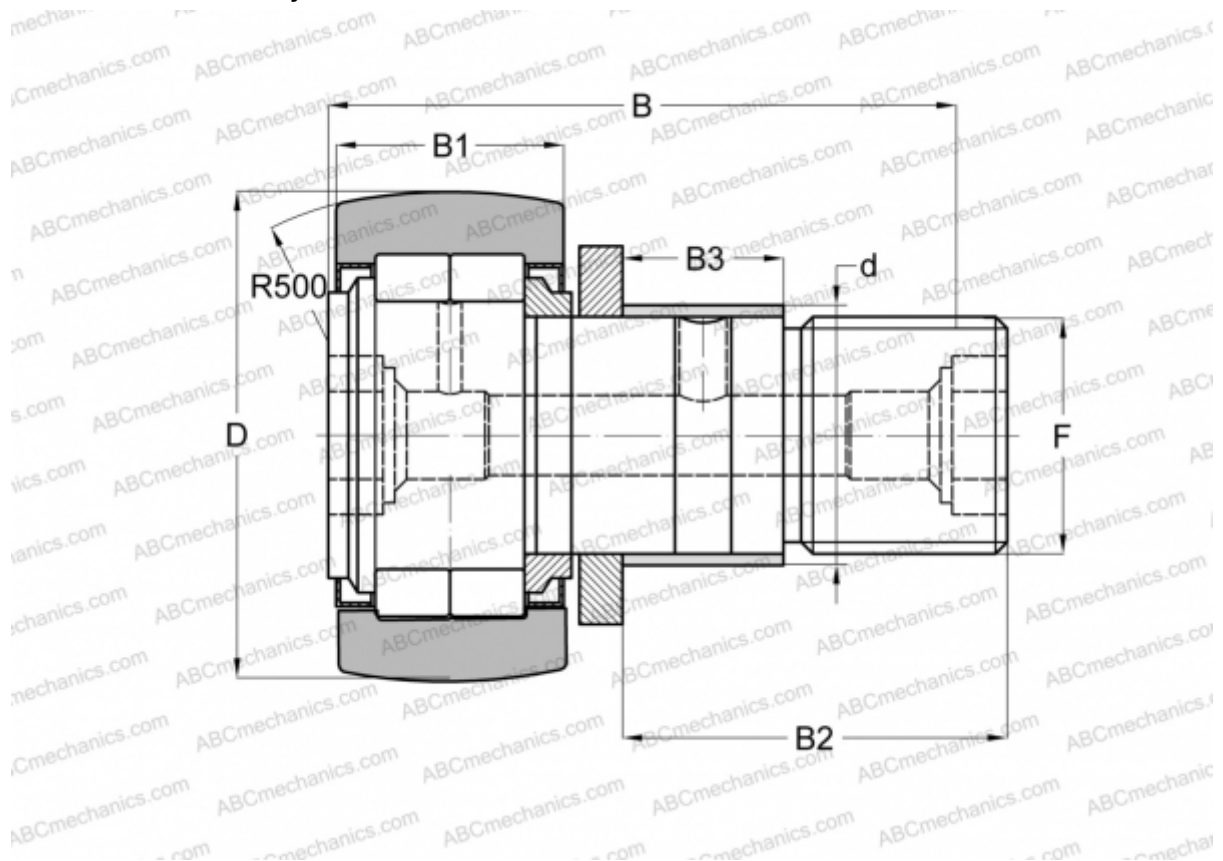

### Technical specification

#### DIMENSIONS, MM

d	28,000
D	72,000
B	80,000
B1	29,000
B2	49,500
B3	22,000
F	M24x1,5

**WEIGHT, KG** 1,039

**MANUFACTURER** [ABC](#)

#### INTERCHANGE

FAG	<a href="#">NUKRE 72 C</a>
INA	<a href="#">NUKRE 72</a>
SKF	<a href="#">NUKRE 72 A</a>